

CHARGING SYSTEM

CONTENTS

| | page | page |
|--|------|------|
| GENERAL INFORMATION | | |
| INTRODUCTION | 1 | |
| GENERAL INFORMATION | | |
| INTRODUCTION | | |
| The generator assembly is serviced as a complete assembly. If the generator should be faulty, replace the entire assembly. The only serviceable part is the drive pulley. | | |
| REMOVAL AND INSTALLATION | | |
| GENERATOR | | |
| REMOVAL | | |
| WARNING: DISCONNECT THE NEGATIVE BATTERY CABLE BEFORE REMOVING THE GENERATOR OUTPUT WIRE FROM THE GENERATOR. FAILURE TO DO SO CAN RESULT IN PERSONAL INJURY OR DAMAGE TO THE VEHICLE ELECTRICAL SYSTEM. | | |
| (1) Open the hood and disconnect the negative battery cable. | | |
| (2) Remove the accessory drive belt from the generator pulley (Fig. 1). Refer to Group 7, Cooling System for the procedure. | | |
| REMOVAL AND INSTALLATION | | |
| GENERATOR | | |
| REMOVAL AND INSTALLATION | | |
| GENERATOR | | |
| GENERATOR | 1 | |

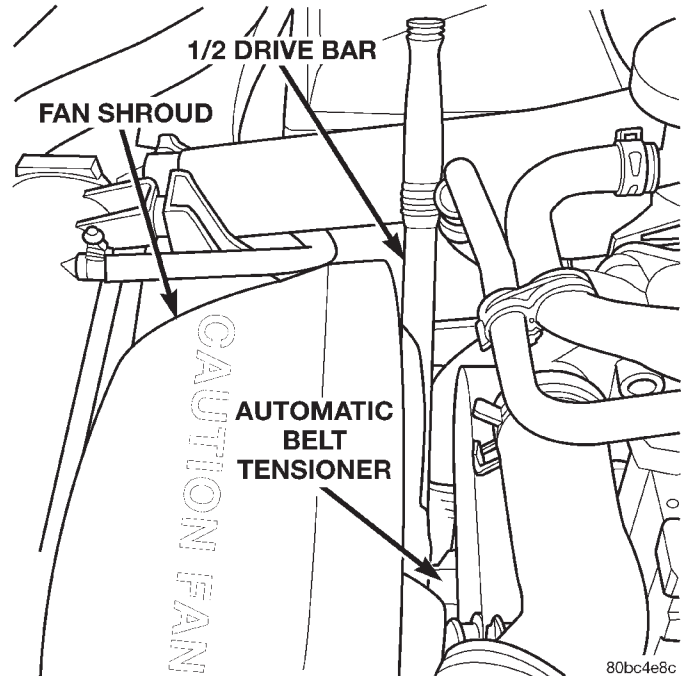

Fig. 1 Removing The Accessory Drive Belt

(3) Remove the B+ generator output wire cap and remove the wire from the terminal (Fig. 2).

REMOVAL AND INSTALLATION (Continued)

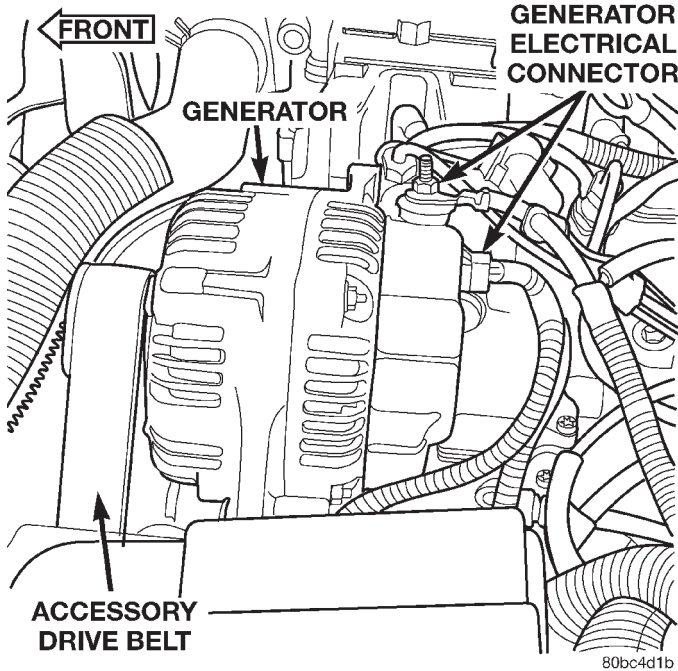

Fig. 2 Generator Electrical

(4) Disconnect the generator field wire connector from the rear of the generator (Fig. 2).

(5) Remove the generator retaining bolts (Fig. 3) and remove the generator from the vehicle.

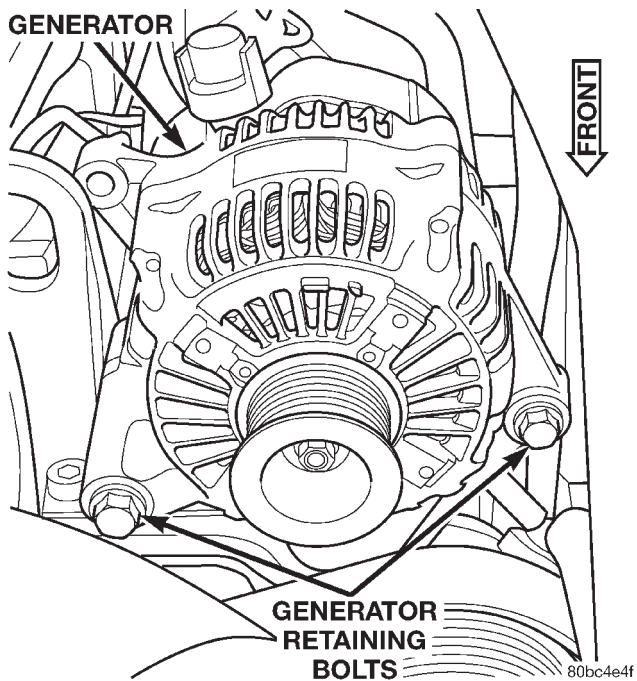

Fig. 3 Generator Retaining Bolts

INSTALLATION

(1) Position the generator and install the retaining bolts (Fig. 4). Torque the bolts to 40 N·m (30 ft. lbs.).

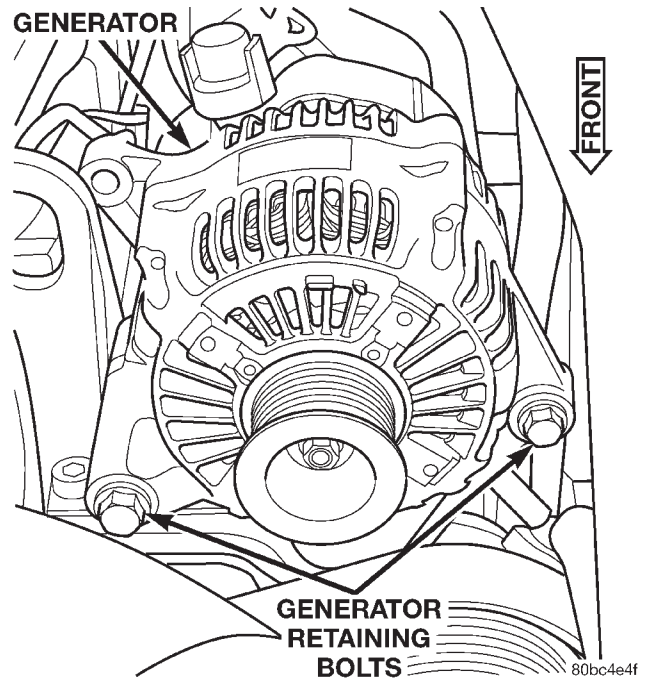

Fig. 4 Generator Retaining Bolts

(2) Connect the generator field wire connector on the rear of the generator (Fig. 5).

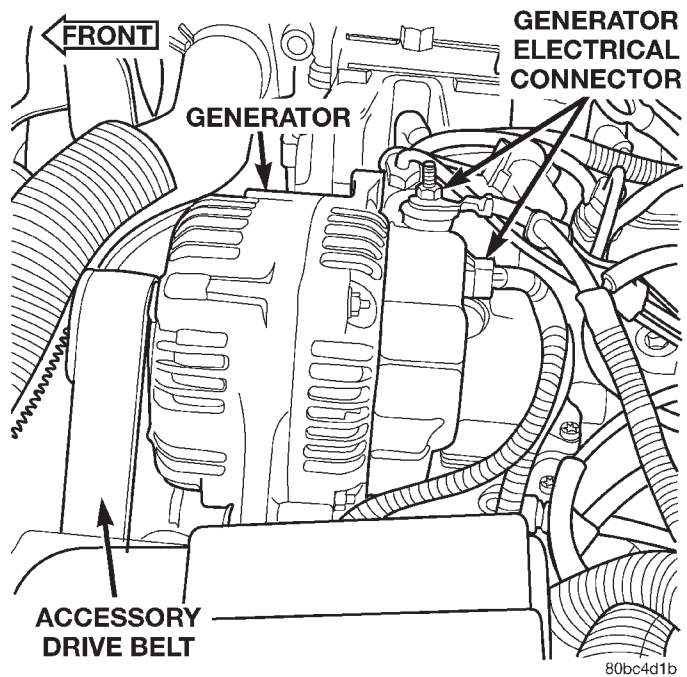

Fig. 5 Generator Electrical

REMOVAL AND INSTALLATION (Continued)

(3) Install the B+ generator output wire and torque to 8.5 N·m (75 in. lbs.) (Fig. 5). Install the terminal cap.

(4) Install the accessory drive belt (Fig. 6). Refer to Group 7, Cooling System for the procedure.

(5) Connect the negative battery cable.

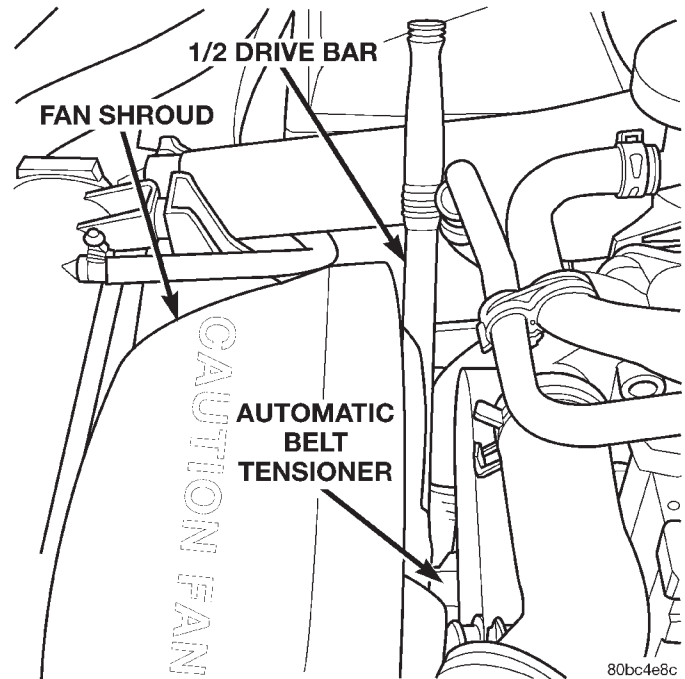

Fig. 6 Installing The Accessory Drive Belt

