

SPEED CONTROL SYSTEM

CONTENTS

	page		page
DESCRIPTION AND OPERATION		ROAD TEST	3
POWERTRAIN CONTROL MODULE	2	SPEED CONTROL SERVO	4
SERVO CABLE	2	SPEED CONTROL SWITCHES	3
SPEED CONTROL SERVO	2	STOP LAMP SWITCH	3
SPEED CONTROL SOLENOID CIRCUITS	2	VACUUM SUPPLY TEST	3
SPEED CONTROL SWITCHES	2	REMOVAL AND INSTALLATION	
SPEED CONTROL SYSTEM	1	SERVO CABLE—4.0L ENGINE	6
STOP LAMP SWITCH	2	SERVO CABLE—4.7L V-8 ENGINE	6
VACUUM RESERVOIR	3	SPEED CONTROL SERVO	4
DIAGNOSIS AND TESTING		SPEED CONTROL SWITCHES	5
ON-BOARD DIAGNOSTIC TEST FOR SPEED		STOP LAMP SWITCH	6
CONTROL SYSTEM	3	VACUUM RESERVOIR	7
OVERSHOOT/UNDERSHOOT FOLLOWING		SPECIFICATIONS	
SPEED CONTROL SET	4	TORQUE CHART	8

DESCRIPTION AND OPERATION

SPEED CONTROL SYSTEM

DESCRIPTION

The speed control system is electronically controlled and vacuum operated. Electronic control of the speed control system is integrated into the Powertrain Control Module (PCM). The controls consist of two steering wheel mounted switches. The switches are labeled: ON/OFF, RES/ACCEL, SET, COAST, and CANCEL.

The system is designed to operate at speeds above 30 mph (50 km/h).

WARNING: THE USE OF SPEED CONTROL IS NOT RECOMMENDED WHEN DRIVING CONDITIONS DO NOT PERMIT MAINTAINING A CONSTANT SPEED, SUCH AS IN HEAVY TRAFFIC OR ON ROADS THAT ARE WINDING, ICY, SNOW COVERED, OR SLIPPERY.

OPERATION

When speed control is selected by depressing the ON switch, the PCM allows a set speed to be stored in PCM RAM for speed control. To store a set speed, depress the SET switch while the vehicle is moving at a speed between 35 and 85 mph. In order for the speed control to engage, the brakes cannot be

applied, nor can the gear selector be indicating the transmission is in Park or Neutral.

The speed control can be disengaged manually by:

- Stepping on the brake pedal
- Depressing the OFF switch
- Depressing the CANCEL switch.

NOTE: Depressing the OFF switch or turning off the ignition switch will erase the set speed stored in the PCM.

For added safety, the speed control system is programmed to disengage for any of the following conditions:

- An indication of Park or Neutral
- An rapid increase rpm (indicates that the clutch has been disengaged)
- Excessive engine rpm (indicates that the transmission may be in a low gear)
- The speed signal increases at a rate of 10 mph per second (indicates that the coefficient of friction between the road surface and tires is extremely low)
- The speed signal decreases at a rate of 10 mph per second (indicates that the vehicle may have decelerated at an extremely high rate)

Once the speed control has been disengaged, depressing the RES/ACCEL switch (when speed is greater than 30 mph) restores the vehicle to the target speed that was stored in the PCM.

While the speed control is engaged, the driver can increase the vehicle speed by depressing the RES/ACCEL switch. The new target speed is stored in the

DESCRIPTION AND OPERATION (Continued)

PCM when the RES/ACCEL is released. The PCM also has a "tap-up" feature in which vehicle speed increases at a rate of approximately 2 mph for each momentary switch activation of the RES/ACCEL switch.

A "tap down" feature is used to decelerate without disengaging the speed control system. To decelerate from an existing recorded target speed, momentarily depress the COAST switch. For each switch activation, speed will be lowered approximately 1 mph.

SPEED CONTROL SERVO

DESCRIPTION

The servo unit consists of a solenoid valve body, a vacuum servo and the mounting bracket.

OPERATION

The Powertrain Control Module (PCM) controls the solenoid valve body. The solenoid valve body controls the application and release of vacuum to the diaphragm of the vacuum servo. A cable connects the servo with the throttle linkage. The servo unit cannot be repaired and is serviced only as a complete assembly.

SPEED CONTROL SOLENOID CIRCUITS

OPERATION

When all of the speed control parameters are met, and the SET button is pressed, the PCM actuates the vent solenoid and "duty-cycles" the vacuum solenoid to open the throttle and bring the vehicle up to target speed. When the vehicle is at target speed, it will actuate the vent solenoid with the vacuum solenoid de-activated to maintain the vehicle at target speed. When the vehicle is above target speed, the PCM will "duty-cycle" the vent solenoid with the vacuum solenoid still de-activated to close the throttle to return to target speed.

SPEED CONTROL SWITCHES

DESCRIPTION

Two separate speed control switch modules are mounted on the steering wheel to the left and right side of the driver's airbag module. The two switch modules are labeled: ON-OFF, SET, RES-ACCEL, CANCEL and COAST. Refer to the owner's manual for more information on speed control switch functions and setting procedures. The individual switches cannot be repaired. If one individual switch fails, the switch module must be replaced.

OPERATION

Within the two switch modules, five **momentary** contact switches, supporting seven different speed control functions are used (an eighth function using a diagnostic resistor is used for diagnostic purposes). The outputs from these switches are filtered into one input. The Powertrain Control Module (PCM) determines which output has been applied through **resistive multiplexing**. The input circuit voltage is measured by the PCM to determine which switch function has been selected.

A speed control indicator lamp, located on the instrument panel cluster is energized by the PCM via the J1850 PCI Bus circuits. This occurs when speed control system power has been turned ON, and the engine is running.

STOP LAMP SWITCH

DESCRIPTION

The switch is mounted on the brake pedal mounting bracket under the instrument panel.

OPERATION

Vehicles equipped with the speed control option use a dual function stop lamp switch. The PCM monitors the state of the dual function stop lamp switch. Refer to the Brake section for more information on stop lamp switch service and adjustment procedures.

SERVO CABLE

DESCRIPTION

The speed control servo cable is connected between the speed control vacuum servo diaphragm and the throttle body control linkage.

OPERATION

This cable causes the throttle control linkage to open or close the throttle valve in response to movement of the vacuum servo diaphragm.

POWERTRAIN CONTROL MODULE

DESCRIPTION

The Powertrain Control Module (PCM) is located in the engine compartment.

OPERATION

The speed control electronic control circuitry is integrated into the PCM. The PCM speed control functions are monitored by the On-Board Diagnostics (OBD). All OBD-sensed systems are monitored by the PCM. Each monitored circuit is assigned a Diagnostic Trouble Code (DTC). The PCM will store a DTC in electronic memory for certain failures it detects. See

DESCRIPTION AND OPERATION (Continued)

On-Board Diagnostic Test For Speed Control System in this group for more information. The PCM cannot be repaired and must be replaced if faulty.

VACUUM RESERVOIR

DESCRIPTION

The vacuum reservoir is a plastic storage tank connected to an engine vacuum source by vacuum lines.

OPERATION

The vacuum reservoir is used to supply the vacuum needed to maintain proper speed control operation when engine vacuum drops, such as in climbing a grade while driving. A one-way check valve is used in the vacuum line between the reservoir and the vacuum source. This check valve is used to trap engine vacuum in the reservoir. On certain vehicle applications, this reservoir is shared with the heating/air-conditioning system. The vacuum reservoir cannot be repaired and must be replaced if faulty.

DIAGNOSIS AND TESTING

ROAD TEST

Perform a vehicle road test to verify reports of speed control system malfunction. The road test should include attention to the speedometer. Speedometer operation should be smooth and without flutter at all speeds.

Flutter in the speedometer indicates a problem which might cause surging in the speed control system. The cause of any speedometer problems should be corrected before proceeding. Refer to Group 8E, Instrument Panel and Gauges for speedometer diagnosis.

If a road test verifies a system problem and the speedometer operates properly, check for:

- A Diagnostic Trouble Code (DTC). If a DTC exists, conduct tests per the Powertrain Diagnostic Procedures service manual.
- A misadjusted brake (stop) lamp switch. This could also cause an intermittent problem.
- Loose, damaged or corroded electrical connections at the servo. Corrosion should be removed from electrical terminals and a light coating of Mopar MultiPurpose Grease, or equivalent, applied.
 - Leaking vacuum reservoir.
 - Loose or leaking vacuum hoses or connections.
 - Defective one-way vacuum check valve.
 - Secure attachment of both ends of the speed control servo cable.
 - Smooth operation of throttle linkage and throttle body air valve.

- Failed speed control servo. Do the servo vacuum test.

CAUTION: When test probing for voltage or continuity at electrical connectors, care must be taken not to damage connector, terminals or seals. If these components are damaged, intermittent or complete system failure may occur.

ON-BOARD DIAGNOSTIC TEST FOR SPEED CONTROL SYSTEM

The Powertrain Control Module (PCM) monitors critical input and output circuits of the speed control system, making sure they are operational. A Diagnostic Trouble Code (DTC) is assigned to each input and output circuit monitored by the On-Board Diagnostic (OBD) system. Some circuits are checked continuously and some are checked only under certain conditions.

For DTC information, refer to Diagnostic Trouble Codes in Group 25, Emission Control System. This will include a complete list of DTC's including DTC's for the speed control system.

SPEED CONTROL SWITCHES

To perform a complete test of the speed control switch circuits, refer to the appropriate Powertrain Diagnostic Procedures manual.

STOP LAMP SWITCH

For continuity checks and switch adjustment, refer to Group 5, Brakes.

VACUUM SUPPLY TEST

(1) Disconnect vacuum hose at speed control servo and install a vacuum gauge into the disconnected hose.

(2) Start engine and observe gauge at idle. Vacuum gauge should read at least ten inches of mercury.

(3) If vacuum is less than ten inches of mercury, determine source of leak. Check vacuum line to engine for leaks. Also check actual engine intake manifold vacuum. If manifold vacuum does not meet this requirement, check for poor engine performance and repair as necessary.

(4) If vacuum line to engine is not leaking, check for leak at vacuum reservoir. To locate and gain access to reservoir, refer to Vacuum Reservoir Removal/Installation in this group. Disconnect vacuum line at reservoir and connect a hand-operated vacuum pump to reservoir fitting. Apply vacuum. Reservoir vacuum should not bleed off. If vacuum is being lost, replace reservoir.

DIAGNOSIS AND TESTING (Continued)

(5) Verify operation of one-way check valve and check it for leaks.

(a) Locate one-way check valve. The valve is located in vacuum line between vacuum reservoir and engine vacuum source. Disconnect vacuum hoses (lines) at each end of valve.

(b) Connect a hand-operated vacuum pump to reservoir end of check valve. Apply vacuum. Vacuum should not bleed off. If vacuum is being lost, replace one-way check valve.

(c) Connect a hand-operated vacuum pump to vacuum source end of check valve. Apply vacuum. Vacuum should flow through valve. If vacuum is not flowing, replace one-way check valve. Seal the fitting at opposite end of valve with a finger and apply vacuum. If vacuum will not hold, diaphragm within check valve has ruptured. Replace valve.

SPEED CONTROL SERVO

For complete speed control system diagnosis, including the speed control servo, refer to the appropriate Powertrain Diagnostic Procedures manual.

OVERSHOOT/UNDERSHOOT FOLLOWING SPEED CONTROL SET

If the operator repeatedly presses and releases the set button with their foot off of the accelerator (a "lift foot set" to begin speed control operation), the vehicle may accelerate and exceed the desired set speed by up to 5 MPH (8 km/h) and then decelerate to less than the desired set speed before finally achieving the desired set speed.

The Speed Control has an adaptive strategy that compensates for vehicle-to-vehicle variations in speed control cable lengths. When the speed control is set with the vehicle operators foot off of the accelerator pedal, the speed control thinks there is excessive speed control cable slack and adapts. If the lift foot sets are continually used, the speed control overshoot/undershoot condition will develop.

To "unlearn" the overshoot/undershoot condition, the vehicle operator has to press and release the set button while maintaining the desired set speed with the accelerator pedal (not decelerating or accelerating), and then turn the cruise control switch to the OFF position (or press the CANCEL button if equipped) after waiting 10 seconds. This procedure must be performed approximately 10–15 times to completely unlearn the overshoot/undershoot condition.

REMOVAL AND INSTALLATION**SPEED CONTROL SERVO****REMOVAL**

The speed control servo is attached to a bracket. The bracket and servo assembly are located below the battery tray.

- (1) Disconnect negative battery cable at battery.
- (2) Disconnect positive battery cable at battery.
- (3) Remove air cleaner housing at top of throttle body and disconnect servo cable at throttle body. Refer to Servo Cable Removal/Installation for procedures.
- (4) Remove battery from battery tray.
- (5) Disconnect wiring at battery tray.
- (6) Disconnect positive battery cable at Power Distribution Center (PDC).
- (7) Loosen PDC at battery tray.
- (8) Remove battery tray (3 bolts). While removing battery tray, disconnect battery temperature sensor electrical connector at sensor.
- (9) Disconnect vacuum line at servo vacuum hose fitting (Fig. 1).
- (10) Disconnect electrical connector at servo (Fig. 1).

If servo and mounting bracket are being removed as one assembly, remove two mounting nuts (Fig. 1). These are located above right-front tire. Remove inner fender clips and pry inner fender back slightly to gain access to mounting nuts.

(11) If servo is being removed from its mounting bracket, remove 2 mounting nuts holding servo cable sleeve to bracket (Fig. 2).

(12) Pull speed control cable sleeve and servo away from servo mounting bracket to expose cable retaining clip (Fig. 2) and remove clip. Note: The servo mounting bracket displayed in (Fig. 2) is a typical bracket and may/may not be applicable to this model vehicle.

(13) Remove servo from mounting bracket or, remove servo and mounting bracket as one assembly.

INSTALLATION

- (1) Position servo to mounting bracket.
- (2) Align hole in cable connector with hole in servo pin. Install cable-to-servo retaining clip.
- (3) Insert servo mounting studs through holes in servo mounting bracket.
- (4) Install servo cable mounting nuts (Fig. 2) and tighten to 8.5 N·m (75 in. lbs.) torque. If servo and bracket is being installed as one assembly, install 2 mounting nuts (Fig. 1) and tighten to 23 N·m (200 in. lbs.) torque.
- (5) Connect vacuum line at servo.
- (6) Connect electrical connector at servo.

REMOVAL AND INSTALLATION (Continued)

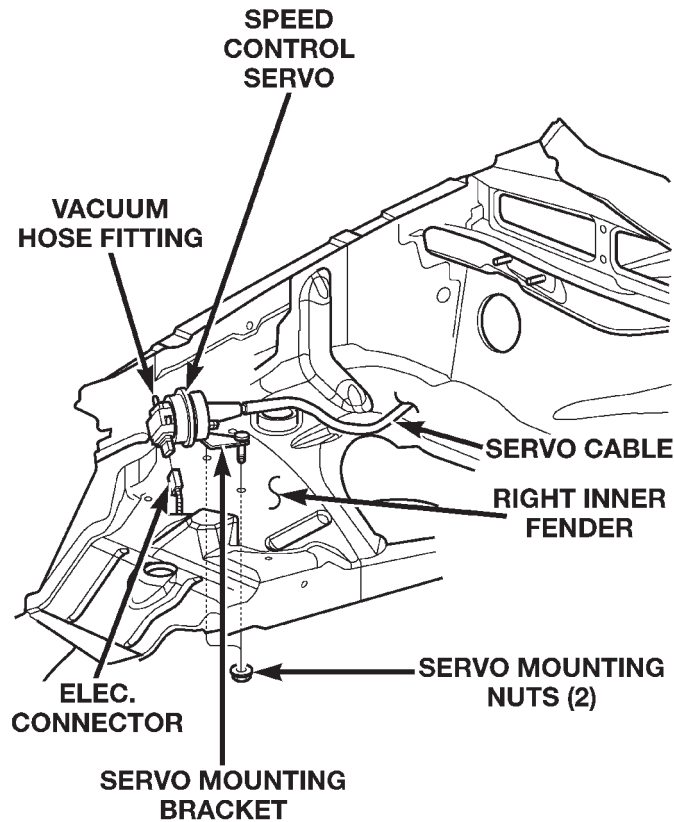

80b77003

Fig. 1 Speed Control Servo Location

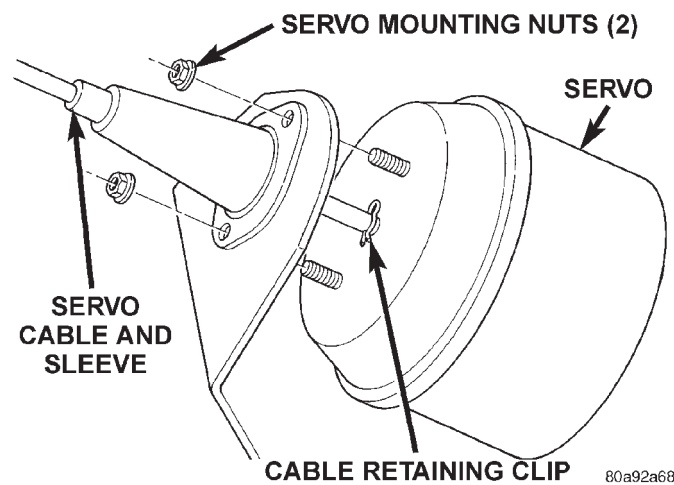

80a92a68

Fig. 2 Servo Cable Clip Remove/Install—Typical

- (7) Connect servo cable to throttle body. Refer to Servo Cable Removal/Installation in this group.
- (8) Install battery tray and battery temperature sensor.
- (9) Connect wiring to battery tray.
- (10) Install battery to battery tray.
- (11) Connect positive battery cable to Power Distribution Center (PDC).
- (12) Connect positive battery cable to battery.

- (13) Connect negative battery cable to battery.
- (14) Before starting engine, operate accelerator pedal to check for any binding.

SPEED CONTROL SWITCHES

REMOVAL

WARNING: BEFORE BEGINNING ANY AIRBAG SYSTEM COMPONENT REMOVAL OR INSTALLATION, REMOVE AND ISOLATE THE NEGATIVE (-) CABLE FROM THE BATTERY. THIS IS THE ONLY SURE WAY TO DISABLE THE AIRBAG SYSTEM. THEN WAIT TWO MINUTES FOR SYSTEM CAPACITOR TO DISCHARGE BEFORE FURTHER SYSTEM SERVICE. FAILURE TO DO THIS COULD RESULT IN ACCIDENTAL AIRBAG DEPLOYMENT AND POSSIBLE INJURY.

- (1) Disconnect and isolate negative battery cable.
- (2) Remove airbag module. Refer to Group 8M, Passive Restraint Systems for procedures.
- (3) Remove electrical connector at switch.
- (4) Remove switch-to-steering wheel mounting screw (Fig. 3).
- (5) Remove switch.

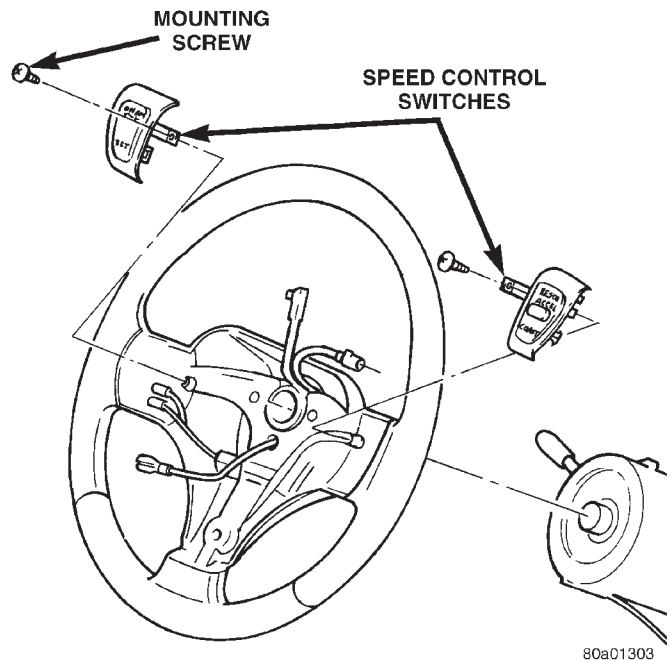

80a01303

Fig. 3 Speed Control Switches

INSTALLATION

- (1) Install switch and mounting screw.
- (2) Tighten screw to 1.5 N-m (15 in. lbs.) torque.
- (3) Install electrical connector to switch.
- (4) Install airbag module. Refer to Group 8M, Passive Restraint Systems for procedures.
- (5) Connect negative battery cable.

REMOVAL AND INSTALLATION (Continued)

STOP LAMP SWITCH

Refer to Stop Lamp Switch in Group 5, Brakes for removal/installation and adjustment procedures.

SERVO CABLE—4.0L ENGINE

REMOVAL

- (1) Disconnect negative battery cable at battery.
- (2) Remove air box housing from throttle body.
- (3) Using finger pressure only, remove speed control cable connector at throttle body bellcrank pin by pushing connector off bellcrank pin towards drivers side of vehicle (Fig. 4). **DO NOT try to pull connector off perpendicular to the bellcrank pin. Connector will be broken.**

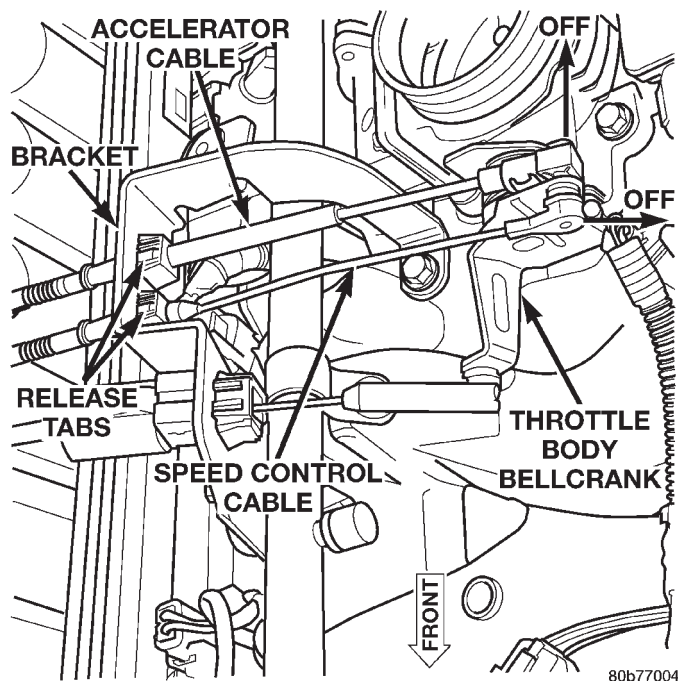

Fig. 4 Speed Control Cable at Bell Crank—4.0L Engine

- (4) Remove cable from cable guide at top of valve cover.
- (5) Squeeze 2 release tabs (Fig. 4) on sides of cable at bracket and push cable out of bracket.
- (6) Remove servo cable from servo. Refer to Speed Control Servo Removal/Installation in this group.

INSTALLATION

- (1) Install end of cable to speed control servo. Refer to Speed Control Servo removal and installation in this group.
- (2) Install cable into mounting bracket (snaps in).
- (3) Install speed control cable connector at throttle body bellcrank pin (snaps on).
- (4) Connect negative battery cable at battery.

- (5) Before starting engine, operate accelerator pedal to check for any binding.

SERVO CABLE—4.7L V-8 ENGINE

REMOVAL

- (1) Disconnect negative battery cable at battery.
- (2) Remove air box housing from throttle body.
The accelerator cable must be partially removed to gain access to speed control cable.
- (3) Using finger pressure only, disconnect accelerator cable connector at throttle body bellcrank pin by pushing connector off bellcrank pin towards front of vehicle (Fig. 5). **DO NOT try to pull connector off perpendicular to the bellcrank pin. Connector will be broken.**
- (4) Lift accelerator cable from top of cable cam (Fig. 5).
- (5) Press tab (Fig. 6) to release plastic cable mount from bracket. **Press on tab only enough to release cable from bracket. If tab is pressed too much, it will be broken.** Slide plastic mount (Fig. 6) towards passenger side of vehicle to remove cable from bracket.
- (6) Using finger pressure only, disconnect speed control cable connector at throttle body bellcrank pin by pushing connector off bellcrank pin towards front of vehicle (Fig. 5). **DO NOT try to pull connector off perpendicular to the bellcrank pin. Connector will be broken.**
- (7) Slide speed control cable plastic mount towards passenger side of vehicle to remove cable from bracket (Fig. 7).
- (8) Remove servo cable from servo. Refer to Speed Control Servo Removal/Installation in this group.

INSTALLATION

- (1) Install end of cable to speed control servo. Refer to Speed Control Servo Removal/Installation.
- (2) Slide speed control cable plastic mount into bracket.
- (3) Install speed control cable connector onto throttle body bellcrank pin (snaps on).
- (4) Slide accelerator cable plastic mount into bracket. Continue sliding until tab (Fig. 6) is aligned to hole in mounting bracket.
- (5) Route accelerator cable over top of cable cam (Fig. 5).
- (6) Install accelerator cable connector onto throttle body bellcrank pin (snaps on).
- (7) Install air box housing to throttle body.
- (8) Connect negative battery cable at battery.
- (9) Before starting engine, operate accelerator pedal to check for any binding.

REMOVAL AND INSTALLATION (Continued)

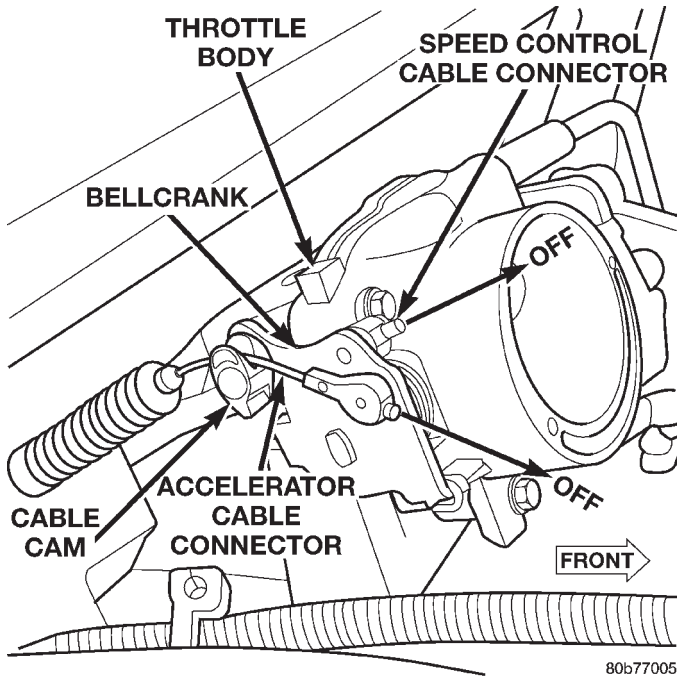

Fig. 5 Cable Connectors at Bell Crank—4.7L V-8 Engine

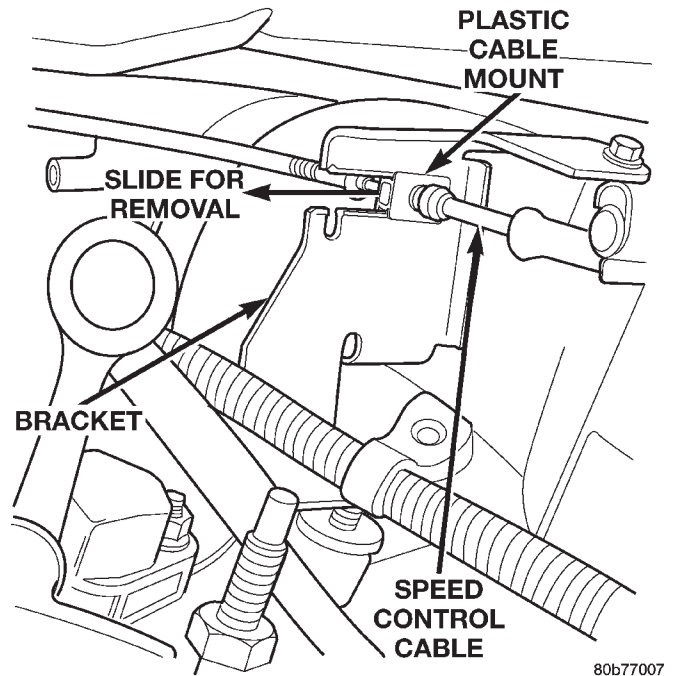

Fig. 7 Speed Control Cable at Bracket—4.7L V-8 Engine

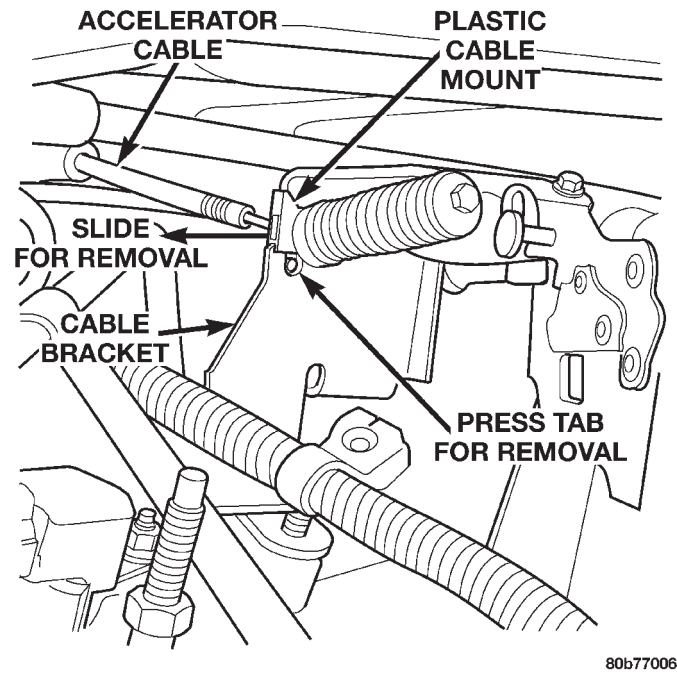

Fig. 6 Accelerator Cable Release Tab—4.7L V-8 Engine

VACUUM RESERVOIR

The vacuum reservoir is located in the right/front corner of the vehicle behind the front bumper fascia (Fig. 8).

REMOVAL

- (1) Remove front bumper and grill assembly.
- (2) Remove 1 support bolt near front of reservoir (Fig. 8).
- (3) Remove 2 reservoir mounting bolts.
- (4) Remove reservoir from vehicle to gain access to vacuum hose (Fig. 9). Disconnect vacuum hose from reservoir fitting at rear of reservoir.

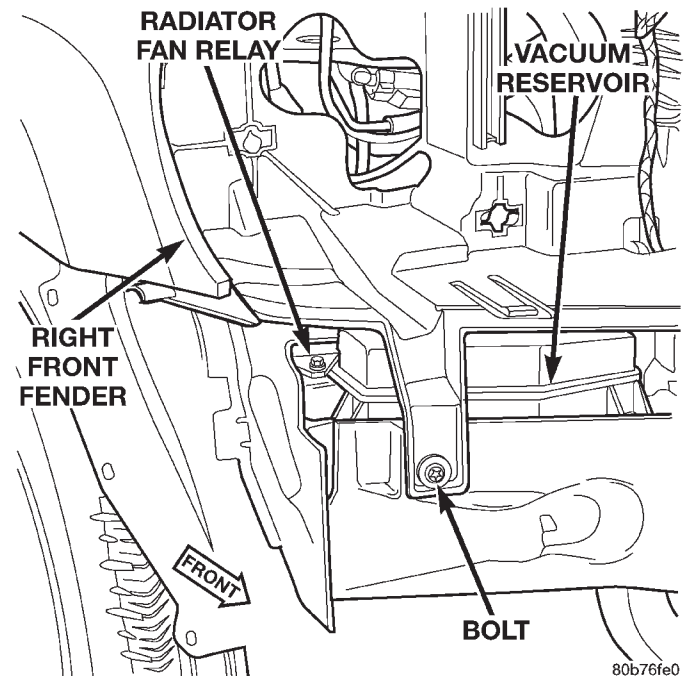
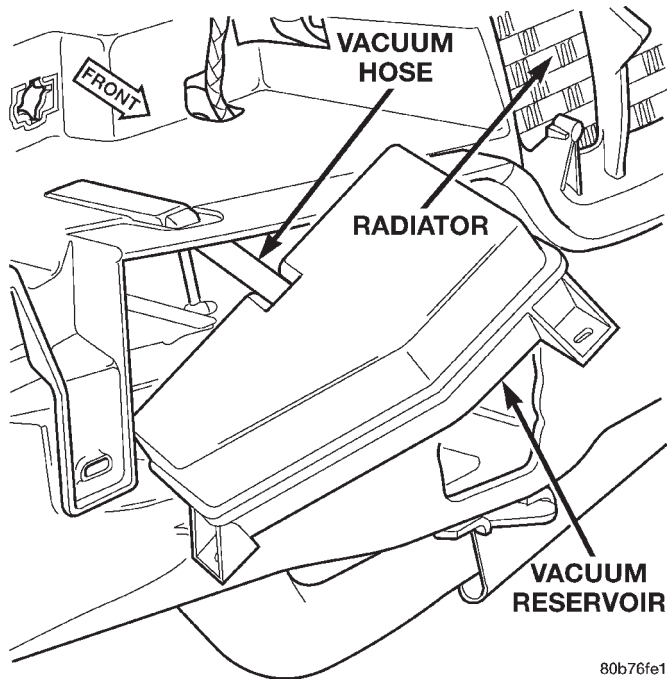

Fig. 8 Vacuum Reservoir Location

REMOVAL AND INSTALLATION (Continued)



80b76fe1

Fig. 9 Vacuum Reservoir Removal/Installation

INSTALLATION

- (1) Connect vacuum hose to reservoir.
- (2) Install reservoir and tighten 2 bolts to 3 N·m (25 in. lbs.) torque.
- (3) Install front bumper and grill assembly.

SPECIFICATIONS

TORQUE CHART

Description	Torque
Servo Mounting Bracket-to-Servo	
Nuts	8.5 N·m (75 in. lbs.)
Servo Mounting Bracket-to-Body	
Nuts	23 N·m (200 in. lbs.)
Switch Module Mounting	
Screws6-1 N·m (6-9 in. lbs.)
Vacuum Reservoir Mounting	
Bolts	3 N·m (25 in. lbs.)