



**NUMBER:** 09-004-07

**GROUP:** Engine

**DATE:** September 25, 2007

*This bulletin is supplied as technical information only and is not an authorization for repair. No part of this publication may be reproduced, stored in a retrieval system, or transmitted, in any form or by any means, electronic, mechanical, photocopying, or otherwise, without written permission of Chrysler LLC.*

**SUBJECT:**

Engine Cranks But Will Not Start

**OVERVIEW:**

This bulletin involves checking for Camshaft and Crankshaft Synchronization using a StarSCAN®. Checking the Julian date on the sensor and if necessary, replacing Crankshaft Position Sensor.

**MODELS:**

2006 - 2008	(LE)	300C/300C Touring (International Markets)
2007 - 2008	(WK)	Grand Cherokee
2005 - 2008	(WH)	Grand Cherokee (International Markets)
2006 - 2008	(XH)	Commander (International Markets)

**NOTE:** This bulletin applies to the above listed vehicles equipped with a 3.0L Diesel engine (sales code EXL) built before the following dates:

- (LE) built before March 29, 2007 (MDH 0329XX)
- (WH) built before March 28, 2007 (MDH 0328XX)
- (WK) built before June 12, 2007 (MDH0612XX)
- (XH) built before March 28, 2007 (MDH 0328XX)

**SYMPTOM/CONDITION:**

The engine cranks but will not start.

**DIAGNOSIS:**

1. Using a StarSCAN®, check for Camshaft/Crankshaft Synchronization.
  - a. Touch "ECU View"
  - b. Touch "PCM"
  - c. Touch "Data Display"
  - d. Scroll Down to "Synchronization." (Crank engine to display reading).
2. Does the StarSCAN® display: "**Not in Sync**" ?
  - a. Yes >>> Proceed to [Step #3](#).
  - b. No >>> This bulletin does not apply, further diagnosis is required.



**Stick with the Specialists™**

3. Remove the Crankshaft Position Sensor and heat shield using the service information available in DealerCONNECT > TechCONNECT > 14 - Fuel System > Fuel Injection - Diesel > Sensor-Crankshaft Position > Removal (Fig. 1).
4. Inspect the Crankshaft Position Sensor for the Julian date. The Julian date is located on the sensor opposite side from the hold down flange (just above mounting surface).
  - An example of a Julian date on the sensor reads as follows: 07 T 59
  - 07 represents the year, 59 represents the day, (59th day of 2007).
5. Is the Julian date 07 T 59 or lower?
  - a. Yes >>> proceed to Repair Procedure.
  - b. No >>> Reinstall original Crankshaft Position Sensor. This bulletin does not apply, further diagnosis is required.

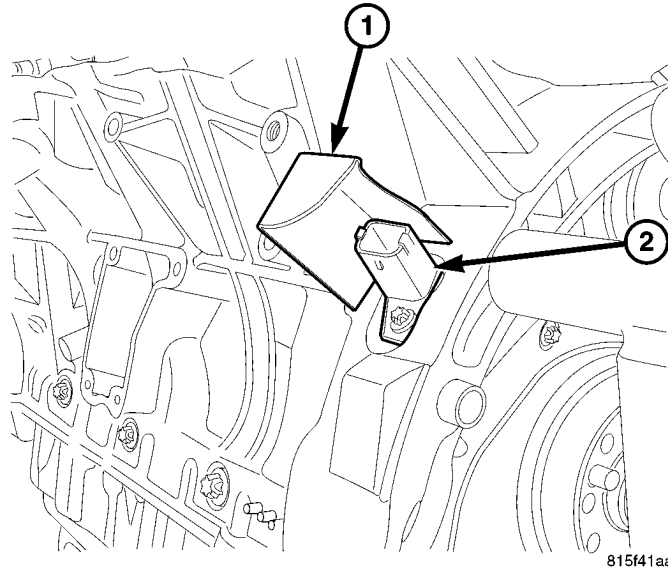

**Fig. 1 CRANKSHAFT POSITION SENSOR**

1 - HEAT SHIELD

2 - CRANKSHAFT POSITION SENSOR

**PARTS REQUIRED:**

Qty.	Part No.	Description
1	05175763AB	Sensor, Crankshaft Position

**REPAIR PROCEDURE:**

1. Replace the Crankshaft Position Sensor using (p/n 05175763AB) Installation procedures available in DealerCONNECT > TechCONNECT > 14 - Fuel System > Fuel Injection - Diesel > Sensor-Crankshaft Position > Installation.

**POLICY:**

Reimbursable within the provisions of the warranty.

**TIME ALLOWANCE:**

<b>Labor Operation No:</b>	<b>Description</b>	<b>Amount</b>
08-15-79-94	Sensor, camshaft position - Inspect & Replace (B)	0.3Hrs.

**FAILURE CODE:**

ZZ	Service Action
----	----------------