

# SCHEDULED SERVICES

## 1993 Jeep Cherokee

1989-96 MAINTENANCE  
Jeep Maintenance & Service Intervals

Jeep; Cherokee (1989-96),  
Wagoneer (1989-90)

### \* PLEASE READ THIS FIRST \*

NOTE: All SERVICE SCHEDULES are listed for normal service vehicles. If vehicle is operated under severe service conditions, see SEVERE SERVICE REQUIREMENTS (PERFORM W/SERVICE SCHEDULES) for items requiring additional maintenance.

NOTE: This article contains scheduled maintenance service information. Fluid types and capacities listed with each service in this article are only those necessary to perform that scheduled service. For specifications pertaining to fluid capacities for the entire vehicle, fuse and circuit breaker identification, wheel and tire size, battery type, warranty information, or model identification refer to the MAINTENANCE INFORMATION article in this section.

### CAUTIONS & WARNINGS

#### SUPPLEMENTAL RESTRAINT SYSTEM (AIR BAG) (1995-96 Models)

NOTE: See the AIR BAGS article in the ACCESSORIES/SAFETY EQUIPMENT Section.

Modifications or improper maintenance, including incorrect removal and installation of the Supplemental Restraint System (SRS), can adversely affect system performance. DO NOT cover, obstruct or change the steering wheel horn pad in any way, as such action could cause improper function of the system. Use only plain water when cleaning the horn pad. Solvents or cleaners could adversely affect the air bag cover and cause improper deployment of the system.

WARNING: To avoid injury from accidental air bag deployment, read and carefully follow all warnings and service precautions. See appropriate AIR BAGS article in ACCESSORIES/SAFETY EQUIPMENT.

WARNING: The Air Bag System installed on 1995 Cherokee models is a sensitive, complex MECHANICAL unit. Before attempting to remove or install the airbag system or related steering wheel and steering column components you MUST FIRST DISARM the AIR BAG firing mechanism. Failure to follow these procedures could result in accidental deployment and personal injury.

WARNING: The air bag module inflator/sensor assembly contains sodium azide and potassium nitrate. These materials are poisonous and extremely flammable. Contact with acid, water or heavy metals may produce harmful & irritating gases or combustible compounds. DO NOT attempt to dismantle the module or tamper with its arming lever. DO NOT attempt puncture, incinerate, or bring into contact with electricity. DO NOT store at temperatures exceeding 200° F.

WARNING: Replace airbag system components with parts specified in the

Chrysler Mopar parts catalog only. DO NOT mix components in this mechanically-fired airbag with components from ANY electrically-fired airbag system.

**WARNING:** The fasteners, screws and bolts used in this air bag system have a special coating on them and are specifically designed for use with this air bag system. DO NOT use any kind of substitute.

**CAUTION:** Disconnect negative battery cable before servicing any air bag system, steering column or passenger side dash component. After any repair, turn ignition key to the ON position from passenger's side of vehicle in case of accidental air bag inflation

## **AIR CONDITIONING MAINTENANCE**

**WARNING:** NEVER add A/C refrigerant to correct a non-cooling problem unless pressure gauges are connected to the system by a certified technician. Lack of cooling may be caused by a restriction, therefore adding refrigerant can cause a dangerous pressure rise.

## **AIR CONDITIONING SERVICING (1994-96 Models)**

**CAUTION:** Avoid breathing R-134a refrigerant and PAG lubricant vapors, exposure may irritate eyes, nose and throat. To remove R-134a from system use R-134a recycling equipment that meets SAE J2210 specifications. If accidental system discharge occurs, ventilate work area before resuming service.

**WARNING:** R-134a service equipment or vehicle A/C systems SHOULD NOT be pressure tested or leak tested with compressed air. Some mixtures of air/R134a have shown to be combustible at elevated pressures. These mixtures are dangerous and may cause fire and/or explosions. See AIR CONDITIONING SERVICE article in GENERAL INFORMATION section.

## **ANTI-LOCK BRAKE SYSTEM (If Equipped)**

The anti-lock brake system contains electronic equipment that can be susceptible to interference caused by improperly installed or high output radio transmitting equipment. Since this interference could cause the possible loss of the anti-lock braking capability, such equipment should be installed by qualified professionals.

On models equipped with anti-lock brake systems, ALWAYS observe the following cautions:

- \* DO NOT attempt to bleed hydraulic system without first referring to the appropriate ANTI-LOCK BRAKE SYSTEM article in the BRAKES Section.
- \* DO NOT mix tire sizes. As long as tires remain close to the original diameter, increasing the width is acceptable. Rolling diameter must be identical for all 4 tires. Some manufacturers recommend tires of the same brand, style and type. Failure to follow this precaution may cause inaccurate wheel speed readings.
- \* Use ONLY recommended brake fluids. DO NOT use silicone brake fluids in an ABS-equipped vehicle.

## **BATTERY WARNING**

**WARNING:** When battery is disconnected, vehicles equipped with computers may lose memory data. When battery power is restored, driveability problems may exist on some vehicles. These vehicles may require a relearn procedure. See COMPUTER RELEARN PROCEDURES article in GENERAL INFORMATION section.

## REPLACING BLOWN FUSES

Before replacing a blown fuse, remove ignition key, turn off all lights and accessories to avoid damaging the electrical system. Be sure to use fuse with the correct indicated amperage rating. The use of an incorrect amperage rating fuse may result in a dangerous electrical system overload.

## BRAKE PAD WEAR INDICATOR

Indicator will cause a squealing or scraping noise, warning that brake pads need replacement.

## BRAKE FLUID MAINTENANCE

**CAUTION:** Any time a hydraulic brake part is removed and/or replaced, the brake system **MUST BE** flushed. For more information regarding brake maintenance refer to BRAKE SYSTEM article.

## BRAKE WARNING LIGHT

**CAUTION:** If BRAKE warning light is on with parking brake disengaged and engine running, there may be a problem in the hydraulic brake system. Braking effort, brake pedal travel and stopping distances may increase.

## CATALYTIC CONVERTER

To prevent catalytic converter overheating, DO NOT allow engine to idle for more than 20 minutes.

## COOLANT (PROPYLENE-GLYCOL FORMULATIONS)

To avoid possible damage to vehicle use only ethylene-glycol based coolants with a mixture ratio from 44-68% anti-freeze. DO NOT use 100% anti-freeze as it will cause the formation of cooling system deposits. This results in coolant temperatures of over 300° F (149°C) which can melt plastics. 100% anti-freeze has a freeze point of only -8° F (-22°C).

**CAUTION:** Propylene-Glycol Mixtures has a smaller temperature range than Etylene-Gylcol. The temperature ranges (freeze-boil) of a 50/50 Anti-Freeze/Water Mixtures are:

Propylene-Glycol -26° F (-32°C) - 257° F (125°C)  
Ethylene-Glycol -35° F (-37°C) - 263° F (128°C).

**CAUTION:** Propylene-Glycol/Ethylene-Glycol Mixtures can cause the destabilization of various corrosion inhibitors. Also Propylene-Glycol/Ethylene-Glycol has a different specific gravity than Ethylene-Glycol coolant, which will result in inaccurate freeze point calculations.

## COMMAND-TRAC (4WD)

**CAUTION:** NEVER operate a Command-Trac vehicle in 4WD on dry,

hard-surfaced roads for a sustained period. Use 4L only when needed for added pulling power. Operating vehicle in 4WD mode on such roads will cause stress and possible damage to components, as well as make shifting difficult. To reduce shifting effort, drive vehicle in Reverse for a few feet, or drive off hard-surfaced road momentarily to allow tire slippage.

### **FRONT AND REAR DIFFERENTIALS (4WD)**

CAUTION: DO NOT use water, steam, kerosene or gasoline for flushing a differential. ONLY use a flushing oil.

### **TRAC-LOK DIFFERENTIALS (4WD)**

CAUTION: DO NOT flush a rear axle Trac-Lok differential. Trac-Lok differentials may be cleaned only by disassembling the unit and wiping the components with clean, lint-free cloth.

CAUTION: NEVER attempt to engage Low range when vehicle is moving faster than 2-3 MPH, as transfer case damage may result.

### **GASOLINE CONTAINING ALCOHOL**

CAUTION: Exclusive use of gasohol is not recommended. Vehicle test results have shown that significant fuel system corrosion can result when gasohol is used exclusively.

### **HALOGEN BULBS**

WARNING: Halogen bulbs contain pressurized gas which may explode if overheated. DO NOT touch glass portion of bulb with bare hands. Eye protection should be worn when handling or working around halogen bulbs.

### **METHANOL GASOLINE**

CAUTION: Fuel that is more than 5% methanol should not be used in this vehicle. It can corrode metal parts in the fuel system, and damage plastic and rubber parts. Even at 5% methanol or less, solvents and corrosion preventers must be used with this fuel to avoid these problems.

### **OIL FILTER**

CAUTION: The engine oil filter mount has metric threads. Use of a filter with improper threads can result in oil leakage and possible engine damage. Look for M20 x 1.5 symbol on the filter.

### **RADIATOR CAP**

CAUTION: Always disconnect the fan motor when working near the radiator fan. The fan is temperature controlled and could start at any time even when the ignition key is in the OFF position. DO NOT loosen or remove radiator cap when cooling system is hot.

### **RADIATOR FAN**

WARNING: Keep hands away from radiator fan.

## **WHEEL & TIRE WARNINGS**

CAUTION: Replacing original tires with different size tires may result in false speedometer and odometer indications. Check with dealer before using different size tires on vehicle.

CAUTION: Ensure all 4 wheels on vehicle have same tire size, type and circumference in order to provide proper vehicle handling. DO NOT mix radial-ply with bias-ply or bias-belted tires. On 4WD vehicles, if tire size, type and circumference on all 4 wheels are not the same, gear shifting will be adversely affected and can damage transfer case.

CAUTION: Temporary-use spare tires are for emergency use only. DO NOT drive vehicle faster than 50 MPH or more than 100 miles when using spare tire. DO NOT operate vehicle in 4WD mode when using spare tire, as damage to transfer case can result. Temporary-use spare tires have a total tread life of 3,000 miles.

## **TRANSFER CASE**

WARNING: DO NOT leave vehicle unattended with transfer case in Neutral without fully applying parking brake. Transfer case Neutral position disengages both axles and will allow vehicle to move regardless of transmission position.

CAUTION: Never attempt to engage Low range when vehicle is moving faster than 2-3 MPH (3-5 KM/H). Transfer case damage may result.

CAUTION: DO NOT operate vehicle in Low range for extended periods on dry, hard surfaced roads. Damage to components and hard shifting may result.

## **SPARK PLUG REPLACEMENT INTERVALS**

Spark plug replacement intervals, if given, are for Original Equipment Manufacturer (OEM) installed or specified plugs. If vehicle is equipped with platinum type or other non-OEM type spark plugs, follow replacement interval specified by spark plug manufacturer.

## **OXYGEN SENSOR**

If vehicle is equipped with an oxygen sensor, replace at 82,500 miles or when the emissions maintenance reminder light remains on continuously with the key in the ON position, whichever occurs first.

## **SERVICE POINT LOCATIONS**

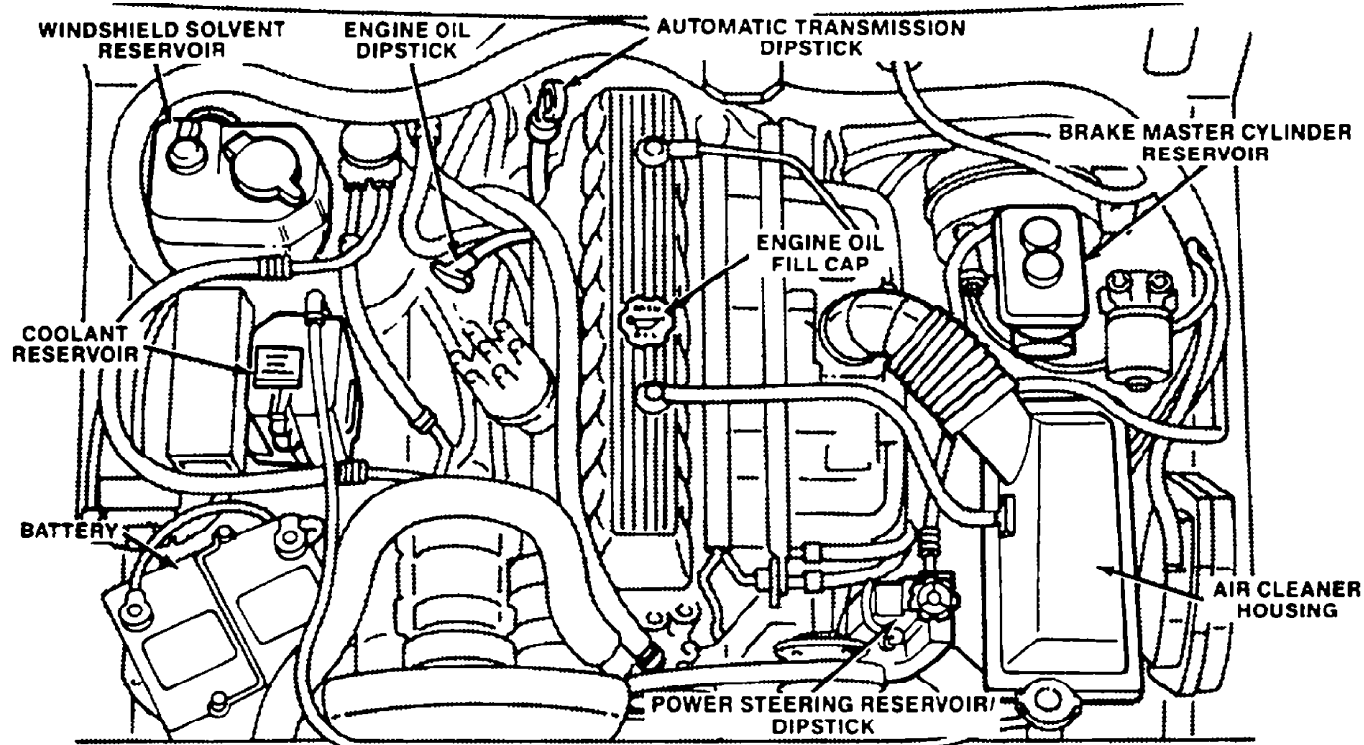

5011724

Fig. 1: Service Point Locations (Typical)  
Courtesy of Chrysler Corp.

### ADDITIONAL SERVICE INFORMATION

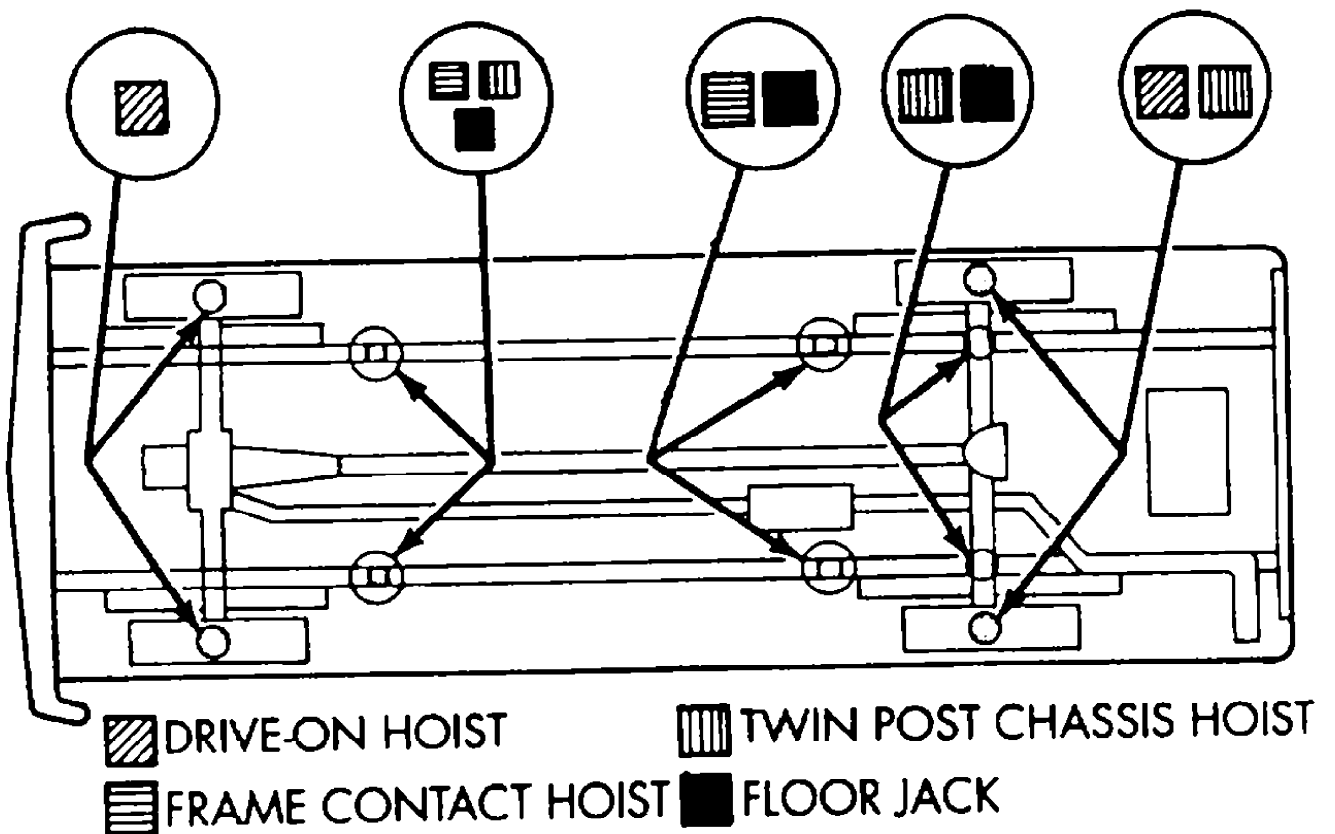
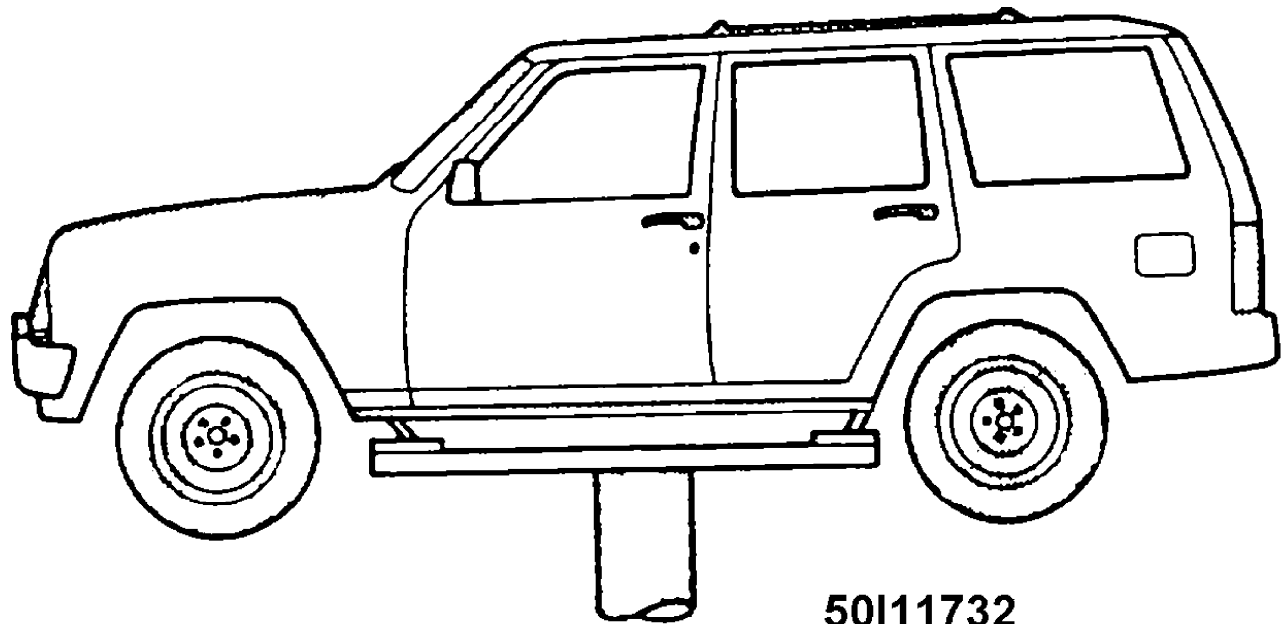
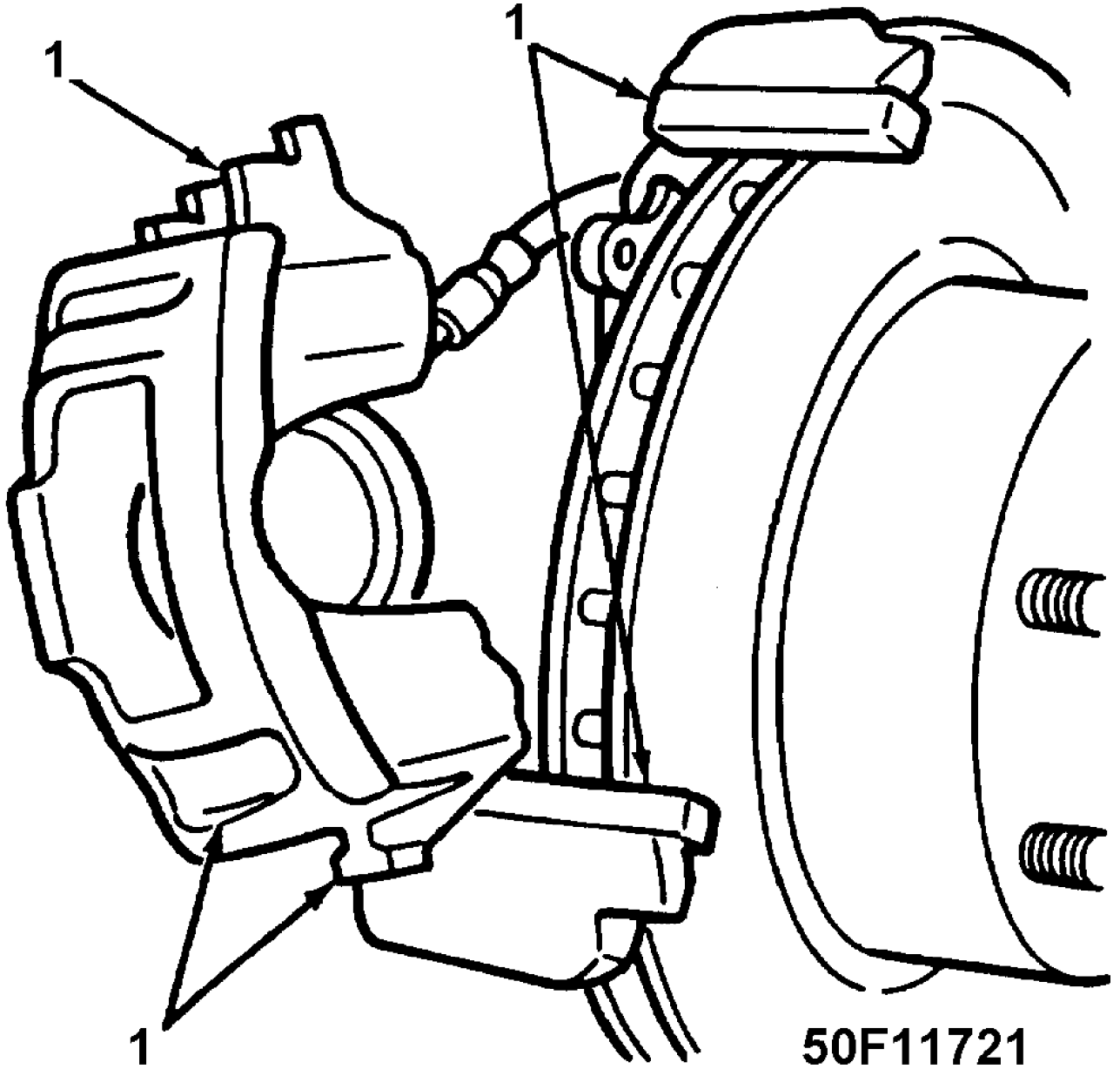

Fig. 2: Hoist Lift Point Locations  
 Courtesy of Chrysler Corp.

NOTE: For more information regarding jacking and hoisting refer to the JACKING & HOISTING article in the

WHEEL ALIGNMENT section.



## 1. LUBRICATION POINTS

Fig. 3: Brake Caliper Lubrication Points  
Courtesy of Chrysler Corp.

NOTE: For more information regarding brake maintenance refer to the BRAKE SYSTEM article in the BRAKES section.



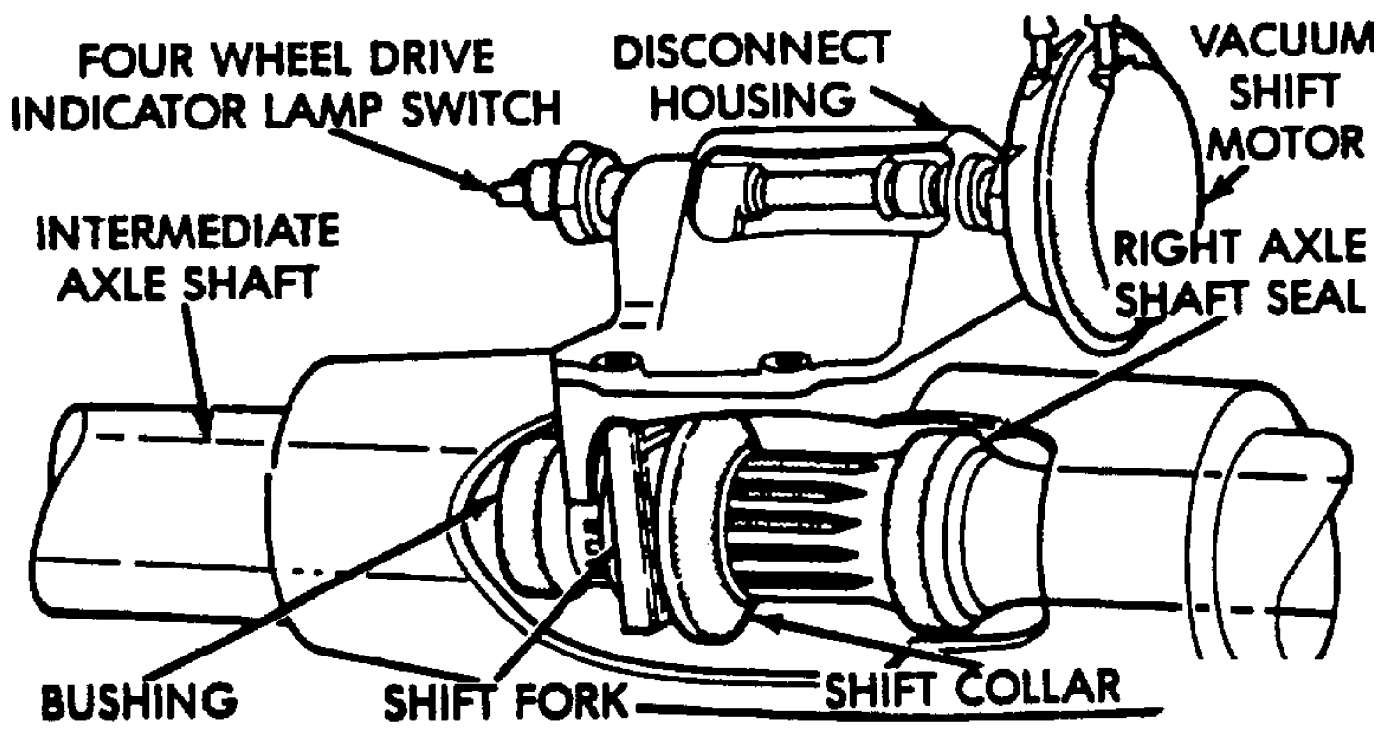

50J11733

Fig. 4: Front Disconnect Housing Lubrication Point  
 Courtesy of Chrysler Corp.

**IDENTIFICATION LABEL LOCATIONS**

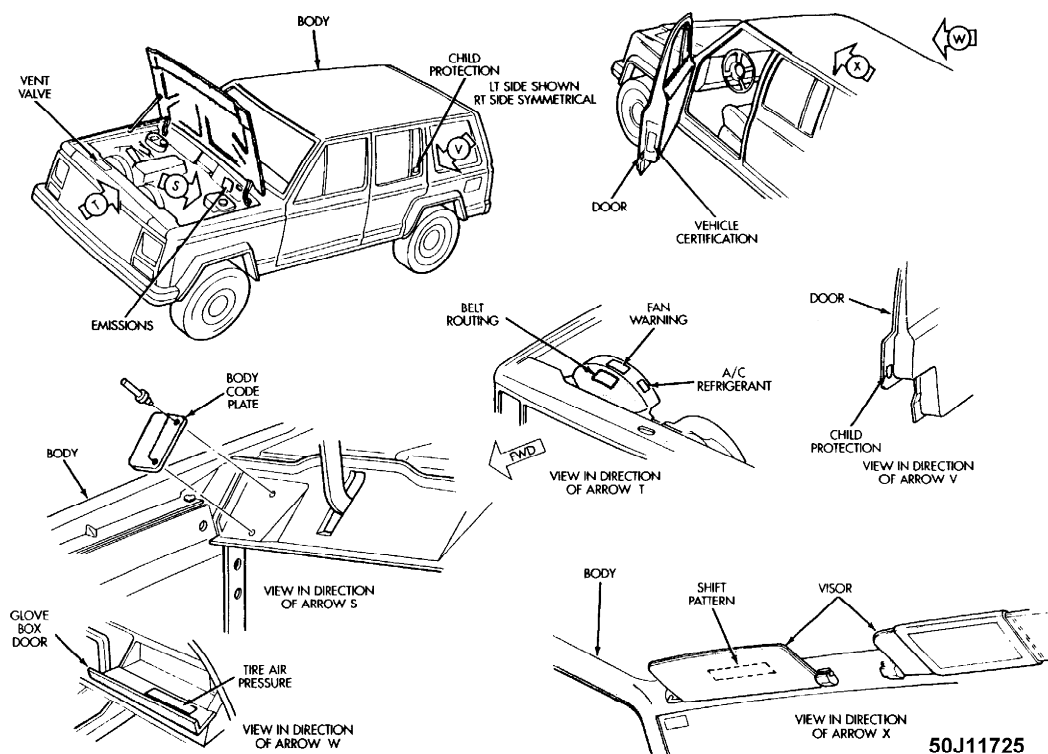

**VEHICLE, LABELS AND PLATES**

Fig. 5: Identification Label Locations  
 Courtesy of Chrysler Corp.

**SEVERE & NORMAL SERVICE DEFINITIONS**

NOTE: Use the Severe Service schedule if the vehicle to be serviced is operated under ANY (one or more) of these conditions:

Service is recommended at mileage intervals based on vehicle operation. Normal Service and Severe Service are based on the following primary operating conditions:

Severe Service

- \* Short Trips (About 15 Miles)
- \* Desert Or Cold Climate Operation
- \* Towing Or Heavily Loaded
- \* Severe Dust Conditions
- \* Hot Weather, Stop-And-Go Driving
- \* Sustained High Speed Driving
- \* Extensive Idling Conditions (Taxi Or Delivery-Type Service)
- \* Driving Off-Road Or In Salty Or Sandy Areas
- \* Operation In Water

Normal Service

- \* Driven More Than 10 Miles Daily
- \* No Severe Service Operating Conditions

**SEVERE SERVICE REQUIREMENTS (PERFORM W/SERVICE SCHEDULES)**

NOTE: The following services are to be performed on vehicles

subjected to severe service. See SEVERE & NORMAL SERVICE DEFINITIONS. This service is to be performed in addition to the normal services listed in the NORMAL MAINTENANCE SERVICE SCHEDULES.

SEVERE SERVICE CONDITIONS/ACTIONS TABLE

Condition	Action	Item	Perform Every (1)
Short Trips (About 15 Miles)	Replace	Engine Oil	3,000 Miles or 3 Months
	Service	Lubricate Propeller Shaft Universal Joints If Equipped With Fittings	3,000 Miles
	Replace	Engine Oil Filter	6,000 Miles or 6 Months
	Replace	A/T Fluid	12,000 Miles
	Replace	Front & Rear Axle Fluid	12,000 Miles
	Replace	M/T Oil	18,000 Miles
Desert Or Cold Climate Operation	Replace	Engine Oil	3,000 Miles or 3 Months
	Service	Lubricate Propeller Shaft Universal Joints If Equipped With Fittings	3,000 Miles
	Replace	Engine Oil Filter	6,000 Miles or 6 Months
	Replace	A/T Fluid	12,000 Miles
	Replace	Front & Rear Axle Fluid	12,000 Miles
	Replace	M/T Oil	18,000 Miles
Towing Or Heavily Loaded	Replace	Engine Oil	3,000 Miles or 3 Months
	Service	Lubricate Propeller Shaft Universal Joints If Equipped With Fittings	3,000 Miles
	Replace	Engine Oil Filter	6,000 Miles or 6 Months
	Replace	A/T Fluid	12,000 Miles

	Replace	Front & Rear Axle Fluid	12,000 Miles
	Replace	M/T Oil	18,000 Miles
Severe Dust Conditions	Replace	Engine Oil	3,000 Miles or 3 Months
	Service	Lubricate Propeller Shaft Universal Joints If Equipped With Fittings	3,000 Miles
	Replace	Engine Oil Filter	6,000 Miles or 6 Months
	Replace	A/T Fluid	12,000 Miles
	Replace	Front & Rear Axle Fluid	12,000 Miles
	Replace	M/T Oil	18,000 Miles
	Hot Weather, Stop-And-Go Driving	Replace	Engine Oil
Service		Lubricate Propeller Shaft Universal Joints If Equipped With Fittings	3,000 Miles
Replace		Engine Oil Filter	6,000 Miles or 6 Months
Replace		A/T Fluid	12,000 Miles
Replace		Front & Rear Axle Fluid	12,000 Miles
Replace		M/T Oil	18,000 Miles
Sustained High Speed Driving		Replace	Engine Oil
	Service	Lubricate Propeller Shaft Universal Joints If Equipped With Fittings	3,000 Miles
	Replace	Engine Oil Filter	6,000 Miles or 6 Months
	Replace	A/T Fluid	12,000 Miles
	Replace	Front & Rear Axle Fluid	12,000 Miles

	Replace	M/T Oil	18,000 Miles
Extensive Idling Conditions (Taxi Or Delivery-Type Service)	Replace	Engine Oil	3,000 Miles or 3 Months
	Service	Lubricate Propeller Shaft Universal Joints If Equipped With Fittings	3,000 Miles
	Replace	Engine Oil Filter	6,000 Miles or 6 Months
	Replace	A/T Fluid	12,000 Miles
	Replace	Front & Rear Axle Fluid	12,000 Miles
	Replace	M/T Oil	18,000 Miles
	Driving Off-Road	Replace	4WD: Engine Oil
Service		Lubricate Front Axle, Steering & Clutch Linkages, Axle & Driveshaft U	1,000 Miles
Service		Lubricate A/T External Controls	1,000 Miles
Inspect		Front Wheel Bearings	1,000 Miles
Inspect		Disc & Drum Brake Systems, Hoses & Lines	1,000 Miles
Service		Lubricate Brake Caliper Slide Rails	1,000 Miles
Inspect		Exhaust System For Leaks, Damage, Or Loose Parts	1,000 Miles
Service		Remove Any Foreign Material Trapped By Exhaust Shielding	1,000 Miles

	Service	Lubricate Clutch Release Lever Pivot	1,000 Miles
	Replace	Engine Oil	3,000 Miles or 3 Months
	Service	Lubricate Propeller Shaft Universal Joints If Equipped With Fittings	3,000 Miles
	Replace	Engine Oil Filter	6,000 Miles or 6 Months
	Replace	A/T Fluid	12,000 Miles
	Replace	Front & Rear Axle Fluid	12,000 Miles
	Replace	M/T Oil	18,000 Miles
Operation In Water	Service	Lubricate Front Axle, Steering & Clutch Linkages, Axle & Driveshaft U	Daily
	Service	Lubricate A/T External Controls	Daily
	Inspect	Front Wheel Bearings	Daily
	Inspect	Disc & Drum Brake Systems, Hoses & Lines	Daily
	Service	Lubricate Brake Caliper Slide Rails	Daily
	Inspect	Exhaust System For Leaks, Damage, Or Loose Parts	Daily
	Service	Remove Any Foreign Material Trapped By Exhaust Shielding	Daily

	Service	Lubricate Clutch Release Lever Pivot	Daily
	Replace	Engine Oil	3,000 Miles or 3 Months
	Service	Lubricate Propeller Shaft Universal Joints If Equipped With Fittings	3,000 Miles
	Replace	Engine Oil Filter	6,000 Miles or 6 Months
	Replace	A/T Fluid	12,000 Miles
	Replace	Front & Rear Axle Fluid	12,000 Miles
	Replace	M/T Oil	18,000 Miles
Driving In Salty Or Sandy Areas	Replace	Engine Oil	3,000 Miles or 3 Months
	Service	Lubricate Propeller Shaft Universal Joints If Equipped With Fittings	3,000 Miles
	Replace	Engine Oil Filter	6,000 Miles or 6 Months
	Replace	A/T Fluid	12,000 Miles
	Replace	Front & Rear Axle Fluid	12,000 Miles
	Replace	M/T Oil	18,000 Miles
	(1) - Perform these services at the mileage or number of months (since the last time), whichever comes first.		

## NORMAL MAINTENANCE SERVICE SCHEDULES

CAUTION: The following service schedules refer to vehicles driven under normal operating conditions. For vehicles driven under severe conditions, additional services may be necessary. See SEVERE SERVICE REQUIREMENTS (PERFORM W/SERVICE SCHEDULES) above in this article for additional service requirements.

### 7,500 MILE (12,000 KM) SERVICE

7,500 MILE (12,000 KM) SERVICE

Service Or Inspect	
	Check Fluid Levels
	Inspect Coolant Hoses and Clamps
	Inspect Brake System
	Inspect Exhaust System
	Inspect Underside of Vehicle (Bolts & Threaded Fasteners)
	Inspect C/V Joint boots (4WD)
	Check Drive Shaft Seals
	Lubricate Ball Joints, Steering Linkage & Suspension
	Lube Drive Shaft U-Joints and Slip Splines
	Lube Front Axle Drive Joint and Pivot Bearings (4WD)
	Check/Lube Manual Steering Gear
	Rotate Tires and Adjust Air Pressure (Including Spare)
Replace	
	Engine Oil
	Oil Filter
Lubrication Specifications	

Application	Specification
Automatic Transmission	
30RH (3-Speed) (1)	Mopar 7176 ATF PLUS
AW4 (4-Speed)	Dexron-IIIE/Mercon ATF
Brake Master Cylinder	DOT 3 (SAE J-1703F) Brake Fluid
Engine Coolant	50/50 Ethylene-Glycol & Water Mix
Engine Oil (2)	
Temperatures Above 0°F (-18°C)	SAE 10W-30 API SH/CD ECII
Temperatures Below 32°F (0°C)	SAE 5W-30 API SH/CD ECII
Front Axle (3)	SAE 80W-90 API GL-5 (MIL-L-2105C)
Rear Axle	SAE 80W-90 API GL-5 (MIL-L-2105C)
Rear Axle (Trac-Lok) (4)	SAE 80W-140 API GL-5
Rear Axle (Trailer Towing) (5)	SAE 75W-140 Synthetic
Hydraulic Clutch	DOT 3 (SAE J-1703F) Brake Fluid
Manual Transmission	SAE 75W-90 API GL-5
Manual Steering Box	Multi-Purpose NLGI Grade 2EP
Power Steering Pump	Power Steering Fluid
Transfer Case	Dexron-IIIE ATF
Parking Brake Cable Guides	NLGI Grade 2, GC-LB
Brake Caliper Bushings	GE 661 or DOW 111 Silicone Grease
Caliper Slide Pins	GE 661 or DOW 111 Silicone Grease
Door & Hood Hinges	Light Engine Oil
Wheel Bearings	Multi-Purpose NLGI Grade 2EP, GC-LB
Drive Shaft U-Joints	Multi-Purpose NLGI Grade 2EP, GC-LB
Steering Linkage (6) (7)	Multi-Purpose NLGI Grade 2EP, GC-LB
Ball Joints (6) (8)	Multi-Purpose NLGI Grade 2EP, GC-LB
Wheel Lug Nut Torque	80-110 ft. lbs. (115-145 N.m)



- (1) - DO NOT use Dexron-II ATF, Clutch chatter can result.
- (2) - SAE 10W-30 SH/CD is preferred.
- (3) - DO NOT use heavier weight lubricant, as it will cause axle engagement difficulties, use only SAE 80W-90 lube.
- (4) - Add 4 ozs. (118 ml) of Limited-Slip differential lubricant additive when changing fluid.
- (5) - For vehicles operating under heavy-duty towing conditions, use SAE 75W-140 Synthetic lube.  
NOTE: Before using SAE 75W-140 Synthetic, old fluid must be DRAINED and FLUSHED with clean mineral based (non-synthetic) axle lubricant. Then refill with new synthetic lube.
- (6) - Use low pressure grease gun to prevent seal damage.
- (7) - Fill until lubricant squeezes out from the base of seals.
- (8) - Fill ball joint until seal starts to swell.

Fluid Capacities

Application	(1) Quantity
Engine Oil (2)	
2.5L .....	4.0 Qts. (3.8L)
4.0L .....	6.0 Qts. (5.7L)

- (1) - Capacities are recommended or calculated levels. Always use dipstick (if available) to measure level.
- (2) - Includes Filter.

**15,000 MILE (24,000 KM) SERVICE**

15,000 MILE (24,000 KM) SERVICE

Service Or Inspect
Verify Last Major Service Was Performed
Check Fluid Levels
Check Cooling System Hoses and Clamps
Check Coolant Strength
Check Exhaust System & Heat Shielding
Clean Battery and Battery Terminals
Accessory Drive Belts
Inspect Brake System
Inspect Underside of Vehicle (Bolts & Threaded Fasteners)
Inspect C/V Joint boots (4WD)
Check Drive Shaft Seals
Lubricate Ball Joints, Steering Linkage & Suspension
Lube Drive Shaft U-Joints and Slip Splines
Lube Front Axle Drive Joint and Pivot Bearings (4WD)

Check/Lube Manual Steering Gear
Check Operation of Horn, Wipers/Washers & All Exterior Lights
Inspect Condition of Wiper Blades
Check Headlight Alignment
Check Seat Belt Webbing and Release Mechanisms
Check Parking Brake Operation
Check Shift/Clutch Interlock Operation
Lubricate Weatherstripping with Silicone
Lubricate Door Hinges
Lubricate Door Locks
Check Body Drain Holes
Rotate Tires and Adjust Air Pressure
Replace
Engine Oil
Oil Filter

Lubrication Specifications

Application	Specification
Automatic Transmission	
30RH (3-Speed) (1)	Mopar 7176 ATF PLUS
AW4 (4-Speed)	Dexron-IIIE/Mercon ATF
Brake Master Cylinder	DOT 3 (SAE J-1703F) Brake Fluid
Engine Coolant	50/50 Ethylene-Glycol & Water Mix
Engine Oil (2)	
Temperatures Above 0°F (-18°C)	SAE 10W-30 API SH/CD ECII
Temperatures Below 32°F (0°C)	SAE 5W-30 API SH/CD ECII
Front Axle (3)	SAE 80W-90 API GL-5 (MIL-L-2105C)
Rear Axle	SAE 80W-90 API GL-5 (MIL-L-2105C)
Rear Axle (Trac-Lok) (4)	SAE 80W-140 API GL-5
Rear Axle (Trailer Towing) (5)	SAE 75W-140 Synthetic
Hydraulic Clutch	DOT 3 (SAE J-1703F) Brake Fluid
Manual Transmission	SAE 75W-90 API GL-5
Manual Steering Box	Multi-Purpose NLGI Grade 2EP
Power Steering Pump	Power Steering Fluid
Transfer Case	Dexron-IIIE ATF
Parking Brake Cable Guides	NLGI Grade 2, GC-LB
Brake Caliper Bushings	GE 661 or DOW 111 Silicone Grease
Caliper Slide Pins	GE 661 or DOW 111 Silicone Grease
Door & Hood Hinges	Light Engine Oil
Wheel Bearings	Multi-Purpose NLGI Grade 2EP, GC-LB
Drive Shaft U-Joints	Multi-Purpose NLGI Grade 2EP, GC-LB
Steering Linkage (6)(7)	Multi-Purpose NLGI Grade 2EP, GC-LB
Ball Joints (6)(8)	Multi-Purpose NLGI Grade 2EP, GC-LB
Weatherstrip	Silicone Spray Lubricant
Wheel Lug Nut Torque	80-110 ft. lbs. (115-145 N.m)

- (1) - DO NOT use Dexron-II ATF, Clutch chatter can result.
- (2) - SAE 10W-30 SH/CD is preferred.
- (3) - DO NOT use heavier weight lubricant, as it will cause axle engagement difficulties, use only SAE 80W-90 lube.
- (4) - Add 4 ozs. (118 ml) of Limited-Slip differential lubricant additive when changing fluid.
- (5) - For vehicles operating under heavy-duty towing conditions, use SAE 75W-140 Synthetic lube.  
NOTE: Before using SAE 75W-140 Synthetic, old fluid must be DRAINED and FLUSHED with clean mineral based (non-synthetic) axle lubricant. Then refill with new synthetic lube.
- (6) - Use low pressure grease gun to prevent seal damage.
- (7) - Fill until lubricant squeezes out from the base of seals.
- (8) - Fill ball joint until seal starts to swell.

Fluid Capacities

Application	(1) Quantity
Engine Oil (5)	
2.5L .....	4.0 Qts. (3.8L)
4.0L .....	6.0 Qts. (5.7L)

- (1) - Capacities are recommended or calculated levels. Always use dipstick (if available) to measure level.
- (2) - Includes Filter.

**22,500 MILE (36,000 KM) SERVICE**

22,500 MILE (36,000 KM) SERVICE

Service Or Inspect
Verify Last Major Service Was Performed
Check Fluid Levels
Check Cooling System Hoses and Clamps
Check Exhaust System & Heat Shielding
Inspect Brake Hoses
Inspect Underside of Vehicle (Bolts & Threaded Fasteners)
Inspect C/V Joint boots (4WD)
Check Drive Shaft Seals
Lubricate Ball Joints, Steering Linkage & Suspension
Lube Drive Shaft U-Joints and Slip Splines
Lube Front Axle Drive Joint and Pivot Bearings (4WD)
Check/Lube Manual Steering Gear
Lube Parking Brake Ratio Lever Pivot
Lube Manual Gearshift Control (4WD Transfer Case)

Inspect Front Brake Pads & Rotors
Inspect Rear Brake Linings & Drums
Inspect Brake System Hoses & Lines
Inspect Shocks for Leakage
Inspect Tire Wear Pattern
Rotate Tires and Adjust Air Pressure (Including Spare)
Replace
Engine Oil
Oil Filter

Lubrication Specifications

Application	Specification
-------------	---------------

Automatic Transmission	
30RH (3-Speed) (1)	Mopar 7176 ATF PLUS
AW4 (4-Speed)	Dexron-IIIE/Mercon ATF
Brake Master Cylinder	DOT 3 (SAE J-1703F) Brake Fluid
Engine Coolant	50/50 Ethylene-Glycol & Water Mix
Engine Oil (2)	
Temperatures Above 0°F (-18°C)	SAE 10W-30 API SH/CD ECII
Temperatures Below 32°F (0°C)	SAE 5W-30 API SH/CD ECII
Front Axle (3)	SAE 80W-90 API GL-5 (MIL-L-2105C)
Rear Axle	SAE 80W-90 API GL-5 (MIL-L-2105C)
Rear Axle (Trac-Lok) (4)	SAE 80W-140 API GL-5
Rear Axle (Trailer Towing) (5)	SAE 75W-140 Synthetic
Hydraulic Clutch	DOT 3 (SAE J-1703F) Brake Fluid
Manual Transmission	SAE 75W-90 API GL-5
Manual Steering Box	Multi-Purpose NLGI Grade 2EP
Power Steering Pump	Power Steering Fluid
Transfer Case	Dexron-IIIE ATF
Parking Brake Cable Guides	NLGI Grade 2, GC-LB
Brake Caliper Bushings	GE 661 or DOW 111 Silicone Grease
Caliper Slide Pins	GE 661 or DOW 111 Silicone Grease
Door & Hood Hinges	Light Engine Oil
Wheel Bearings	Multi-Purpose NLGI Grade 2EP, GC-LB
Drive Shaft U-Joints	Multi-Purpose NLGI Grade 2EP, GC-LB
Steering Linkage (6) (7)	Multi-Purpose NLGI Grade 2EP, GC-LB
Ball Joints (6) (8)	Multi-Purpose NLGI Grade 2EP, GC-LB
Weatherstrip	Silicone Spray Lubricant
Wheel Lug Nut Torque	80-110 ft. lbs. (115-145 N.m)

- (1) - DO NOT use Dexron-II ATF, Clutch chatter can result.
- (2) - SAE 10W-30 SH/CD is preferred.
- (3) - DO NOT use heavier weight lubricant, as it will cause axle engagement difficulties, use only SAE 80W-90 lube.
- (4) - Add 4 ozs. (118 ml) of Limited-Slip differential lubricant additive when changing fluid.
- (5) - For vehicles operating under heavy-duty towing conditions, use SAE 75W-140 Synthetic lube.  
NOTE: Before using SAE 75W-140 Synthetic, old fluid must be DRAINED and FLUSHED with clean mineral based (non-synthetic) axle lubricant. Then refill with new synthetic lube.
- (6) - Use low pressure grease gun to prevent seal damage.
- (7) - Fill until lubricant squeezes out from the base of seals.

(8) - Fill ball joint until seal starts to swell.

Fluid Capacities

Application	(1) Quantity
Engine Oil (5)	
2.5L .....	4.0 Qts. (3.8L)
4.0L .....	6.0 Qts. (5.7L)

- (1) - Capacities are recommended or calculated levels. Always use dipstick (if available) to measure level.
- (2) - Includes Filter.

**30,000 MILE (48,000 KM) SERVICE**

30,000 MILE (48,000 KM) SERVICE

Service Or Inspect
Verify Last Major Service Was Performed
Check Fluid Levels
Check Cooling System Hoses and Clamps
Check Coolant Strength
Check Exhaust System & Heat Shielding
Clean Battery and Battery Terminals
Inspect/Adjust Drive Belt Tension (4.0L)
Inspect Underside of Vehicle (Bolts & Threaded Fasteners)
Inspect C/V Joint boots (4WD)
Check Drive Shaft Seals
Lubricate Ball Joints, Steering Linkage & Suspension
Lube Drive Shaft U-Joints and Slip Splines
Lube Front Axle Drive Joint and Pivot Bearings (4WD)
Check/Lube Manual Steering Gear
Suspension Bushings, Springs, Arms & Rear Jounce Bumpers
Parking Brake System
Lubricate Body Components
Inspect Shocks for Leakage
Inspect Tire Wear Pattern
Rotate Tires and Adjust Air Pressure (Including Spare)
Replace

Engine Oil
Oil Filter
Spark Plugs
Air Filter Element
Automatic Transmission Fluid, Filter and Adjust Bands
Transfer Case Fluid
Front & Rear Axle Fluid

Lubrication Specifications

Application	Specification
-------------	---------------

Automatic Transmission	
30RH (3-Speed) (1)	Mopar 7176 ATF PLUS
AW4 (4-Speed)	Dexron-IIIE/Mercon ATF
Brake Master Cylinder	DOT 3 (SAE J-1703F) Brake Fluid
Engine Coolant	50/50 Ethylene-Glycol & Water Mix
Engine Oil (2)	
Temperatures Above 0°F (-18°C)	SAE 10W-30 API SH/CD ECII
Temperatures Below 32°F (0°C)	SAE 5W-30 API SH/CD ECII
Front Axle (3)	SAE 80W-90 API GL-5 (MIL-L-2105C)
Rear Axle	SAE 80W-90 API GL-5 (MIL-L-2105C)
Rear Axle (Trac-Lok) (4)	SAE 80W-140 API GL-5
Rear Axle (Trailer Towing) (5)	SAE 75W-140 Synthetic
Hydraulic Clutch	DOT 3 (SAE J-1703F) Brake Fluid
Manual Transmission	SAE 75W-90 API GL-5
Manual Steering Box	Multi-Purpose NLGI Grade 2EP
Power Steering Pump	Power Steering Fluid
Transfer Case	Dexron-IIIE ATF
Parking Brake Cable Guides	NLGI Grade 2, GC-LB
Brake Caliper Bushings	GE 661 or DOW 111 Silicone Grease
Caliper Slide Pins	GE 661 or DOW 111 Silicone Grease
Door & Hood Hinges	Light Engine Oil
Wheel Bearings	Multi-Purpose NLGI Grade 2EP, GC-LB
Drive Shaft U-Joints	Multi-Purpose NLGI Grade 2EP, GC-LB
Steering Linkage (6)(7)	Multi-Purpose NLGI Grade 2EP, GC-LB
Ball Joints (6)(8)	Multi-Purpose NLGI Grade 2EP, GC-LB
Weatherstrip	Silicone Spray Lubricant
Wheel Lug Nut Torque	80-110 ft. lbs. (115-145 N.m)

- (1) - DO NOT use Dexron-II ATF, Clutch chatter can result.
- (2) - SAE 10W-30 SH/CD is preferred.
- (3) - DO NOT use heavier weight lubricant, as it will cause axle engagement difficulties, use only SAE 80W-90 lube.
- (4) - Add 4 ozs. (118 ml) of Limited-Slip differential lubricant additive when changing fluid.
- (5) - For vehicles operating under heavy-duty towing conditions, use SAE 75W-140 Synthetic lube.  
NOTE: Before using SAE 75W-140 Synthetic, old fluid must be DRAINED and FLUSHED with clean mineral based (non-synthetic) axle lubricant. Then refill with new synthetic lube.
- (6) - Use low pressure grease gun to prevent seal damage.
- (7) - Fill until lubricant squeezes out from the base of seals.
- (8) - Fill ball joint until seal starts to swell.

Fluid Capacities

Application	(1) Quantity
Automatic Transmission (2)	
30RH (3-Speed)	
Fluid Change .....	4.0 Qts. (3.8L)
Overhaul (Dry Fill) .....	8.75 Qts. (8.2L)
AW4 (4-Speed)	
Fluid Change .....	2.0 Qts. (1.7L)
Overhaul (Dry Fill) .....	8.5 Qts. (8.0L)
Cooling System	
2.5L (3) .....	10.0 Qts. (9.5L)
4.0L (4) .....	12.0 Qts. (11.4L)
Engine Oil (5)	
2.5L .....	4.0 Qts. (3.8L)
4.0L .....	6.0 Qts. (5.7L)
Manual Transmission (6)	
AX4 (4-Speed AISIN) .....	7.4 Pts. (3.5L)
T4 (Borg-Warner) .....	3.9 Pts. (1.8L)
AX5 (5-Speed AISIN)	
2.5L (2WD) .....	7.0 Pts. (3.5L)
2.5L (4X4) .....	6.6 Pts. (3.2L)
T5 (Borg-Warner) .....	4.5 Pts. (2.1L)
AX15 (5-Speed AISIN)	
4.0L (2WD) .....	6.4 Pts. (3.1L)
4.0L (4X4) .....	6.5 Pts. (3.15L)
Transfer Case	
Command-Trac (NV 231) .....	2.2 Pts. (1.0L)
Selec-Trac (NV 242) .....	3.0 Pts. (1.4L)
Drive Axles (6)	
Front Axle (Model 30)	
Command-Trac (Disconnect) .....	3.76 Pts. (1.65L)
(Disconnect Housing) (7) .....	5.0 Ozs. (0.15L)
Selec-Trac (Non-Disconnect) .....	3.13 Pts. (1.5L)
Rear Axle	
1989-94 (8) .....	2.5 Pts. (1.2L)
1995-96	
Model 35 (8) .....	3.5 Pts. (1.6L)
8-1/4" (8) .....	4.4 Pts. (2.1L)

- (1) - Capacities are recommended or calculated levels. Always use dipstick (if available) to measure level.
- (2) - Total quantity required will vary, after adding amount shown check dipstick and fill to proper level.
- (3) - Includes 2.3 qts. (2.2L) for coolant recovery bottle.
- (4) - Includes 1.0 qt. (0.9L) for coolant recovery bottle.
- (5) - Includes Filter.
- (6) - Fill to bottom edge of filler plug hole.
- (7) - Add 5 ozs. of gear lubricant through indicator switch hole.
- (8) - If equipped with TRAC-LOK, add 4 ozs. of Limited-Slip differential lubricant additive first, then add new fluid.

#### Service Labor Times

Application	(1) Hours
2.5L	
Automatic Transmission .....	4.2
Manual Transmission .....	2.4
4.0L	
Automatic Transmission .....	4.3
Manual Transmission .....	2.5

(1) - Add .6 hr. for vehicles equipped with 4WD.

### 37,500 MILE (60,000 KM) SERVICE

#### 37,500 MILE (60,000 KM) SERVICE

Service Or Inspect	
	Verify Last Major Service Was Performed
	Check Fluid Levels
	Check Fuel Lines, Connections
	Check Cooling System Hoses and Clamps
	Check Exhaust System & Heat Shielding
	Inspect Brake System
	Inspect Underside of Vehicle (Bolts & Threaded Fasteners)
	Inspect C/V Joint boots (4WD)
	Check Drive Shaft Seals
	Lubricate Ball Joints, Steering Linkage & Suspension
	Lube Drive Shaft U-Joints and Slip Splines
	Lube Front Axle Drive Joint and Pivot Bearings (4WD)
	Check/Lube Manual Steering Gear
	Rotate Tires and Adjust Air Pressure (Including Spare)
Replace	
	Engine Oil
	Oil Filter
	Manual Transmission Fluid
Lubrication Specifications	
Application	Specification
Automatic Transmission	
30RH (3-Speed) (1)	Mopar 7176 ATF PLUS
AW4 (4-Speed)	Dexron-IIIE/Mercon ATF
Brake Master Cylinder	DOT 3 (SAE J-1703F) Brake Fluid
Engine Coolant	50/50 Ethylene-Glycol & Water Mix
Engine Oil (2)	
Temperatures Above 0°F (-18°C)	SAE 10W-30 API SH/CD ECII
Temperatures Below 32°F (0°C)	SAE 5W-30 API SH/CD ECII
Front Axle (3)	SAE 80W-90 API GL-5 (MIL-L-2105C)
Rear Axle	SAE 80W-90 API GL-5 (MIL-L-2105C)
Rear Axle (Trac-Lok) (4)	SAE 80W-140 API GL-5
Rear Axle (Trailer Towing) (5)	SAE 75W-140 Synthetic
Hydraulic Clutch	DOT 3 (SAE J-1703F) Brake Fluid



Manual Transmission .....	SAE 75W-90 API GL-5
Manual Steering Box .....	Multi-Purpose NLGI Grade 2EP
Power Steering Pump .....	Power Steering Fluid
Transfer Case .....	Dexron-II E ATF
Parking Brake Cable Guides .....	NLGI Grade 2, GC-LB
Brake Caliper Bushings .....	GE 661 or DOW 111 Silicone Grease
Caliper Slide Pins .....	GE 661 or DOW 111 Silicone Grease
Door & Hood Hinges .....	Light Engine Oil
Wheel Bearings .....	Multi-Purpose NLGI Grade 2EP, GC-LB
Drive Shaft U-Joints .....	Multi-Purpose NLGI Grade 2EP, GC-LB
Steering Linkage (6) (7) .....	Multi-Purpose NLGI Grade 2EP, GC-LB
Ball Joints (6) (8) .....	Multi-Purpose NLGI Grade 2EP, GC-LB
Weatherstrip .....	Silicone Spray Lubricant
Wheel Lug Nut Torque .....	80-110 ft. lbs. (115-145 N.m)

- (1) - DO NOT use Dexron-II ATF, Clutch chatter can result.
- (2) - SAE 10W-30 SH/CD is preferred.
- (3) - DO NOT use heavier weight lubricant, as it will cause axle engagement difficulties, use only SAE 80W-90 lube.
- (4) - Add 4 ozs. (118 ml) of Limited-Slip differential lubricant additive when changing fluid.
- (5) - For vehicles operating under heavy-duty towing conditions, use SAE 75W-140 Synthetic lube.  
NOTE: Before using SAE 75W-140 Synthetic, old fluid must be DRAINED and FLUSHED with clean mineral based (non-synthetic) axle lubricant. Then refill with new synthetic lube.
- (6) - Use low pressure grease gun to prevent seal damage.
- (7) - Fill until lubricant squeezes out from the base of seals.
- (8) - Fill ball joint until seal starts to swell.

#### Fluid Capacities

Application	(1) Quantity
Automatic Transmission (2)	
30RH (3-Speed)	
Fluid Change .....	4.0 Qts. (3.8L)
Overhaul (Dry Fill) .....	8.75 Qts. (8.2L)
AW4 (4-Speed)	
Fluid Change .....	2.0 Qts. (1.7L)
Overhaul (Dry Fill) .....	8.5 Qts. (8.0L)
Cooling System	
2.5L (3) .....	10.0 Qts. (9.5L)
4.0L (4) .....	12.0 Qts. (11.4L)
Engine Oil (5)	
2.5L .....	4.0 Qts. (3.8L)
4.0L .....	6.0 Qts. (5.7L)
Manual Transmission (6)	
AX4 (4-Speed AISIN) .....	7.4 Pts. (3.5L)
T4 (Borg-Warner) .....	3.9 Pts. (1.8L)
AX5 (5-Speed AISIN)	
2.5L (2WD) .....	7.0 Pts. (3.5L)
2.5L (4X4) .....	6.6 Pts. (3.2L)
T5 (Borg-Warner) .....	4.5 Pts. (2.1L)
AX15 (5-Speed AISIN)	
4.0L (2WD) .....	6.4 Pts. (3.1L)
4.0L (4X4) .....	6.5 Pts. (3.15L)
Transfer Case	
Command-Trac (NV 231) .....	2.2 Pts. (1.0L)
Selec-Trac (NV 242) .....	3.0 Pts. (1.4L)
Drive Axles (6)	
Front Axle (Model 30)	
Command-Trac (Disconnect) .....	3.76 Pts. (1.65L)

(Disconnect Housing) (7)	.....	5.0 Ozs. (0.15L)
Selec-Trac (Non-Disconnect)	.....	3.13 Pts. (1.5L)
Rear Axle		
1989-94 (8)	.....	2.5 Pts. (1.2L)
1995-96		
Model 35 (8)	.....	3.5 Pts. (1.6L)
8-1/4" (8)	.....	4.4 Pts. (2.1L)

- (1) - Capacities are recommended or calculated levels. Always use dipstick (if available) to measure level.
- (2) - Total quantity required will vary, after adding amount shown check dipstick and fill to proper level.
- (3) - Includes 2.3 qts. (2.2L) for coolant recovery bottle.
- (4) - Includes 1.0 qt. (0.9L) for coolant recovery bottle.
- (5) - Includes Filter.
- (6) - Fill to bottom edge of filler plug hole.
- (7) - Add 5 ozs. of gear lubricant through indicator switch hole.
- (8) - If equipped with TRAC-LOK, add 4 ozs. of Limited-Slip differential lubricant additive first, then add new fluid.

### 45,000 MILE (72,000 KM) SERVICE

#### 45,000 MILE (72,000 KM) SERVICE

Service Or Inspect
Verify Last Major Service Was Performed
Check Fluid Levels
Check Fuel Lines, Connections
Check Cooling System Hoses and Clamps
Check Coolant Strength
Clean Battery and Battery Terminals
Check Exhaust System & Heat Shielding
Check Operation of Horn, Wipers/Washers & All Exterior Lights
Inspect Condition of Wiper Blades
Check Headlight Alignment
Check Seat Belt Webbing and Release Mechanisms
Check Parking Brake Operation
Check Shift/Clutch Interlock Operation
Inspect Underside of Vehicle (Bolts & Threaded Fasteners)
Inspect C/V Joint boots (4WD)
Check Drive Shaft Seals
Lubricate Ball Joints, Steering Linkage & Suspension
Lube Drive Shaft U-Joints and Slip Splines

Lube Front Axle Drive Joint and Pivot Bearings (4WD)
Check/Lube Manual Steering Gear
Lube Parking Brake Ratio Lever Pivot
Lube Manual Gearshift Control (4WD Transfer Case)
Inspect Front Brake Pads & Rotors
Inspect Rear Brake Linings & Drums
Inspect Brake System Hoses & Lines
Inspect Shocks for Leakage
Inspect Tire Wear Pattern
Lubricate Weatherstripping with Silicone
Lubricate Door Hinges
Lubricate Door Locks
Check Body Drain Holes
Rotate Tires and Adjust Air Pressure
Replace
Engine Oil
Oil Filter
Flush and Fill Engine Coolant, if not done in last 36 months

Lubrication Specifications

Application	Specification
Automatic Transmission	
30RH (3-Speed) (1)	Mopar 7176 ATF PLUS
AW4 (4-Speed)	Dexron-IIIE/Mercon ATF
Brake Master Cylinder	DOT 3 (SAE J-1703F) Brake Fluid
Engine Coolant	50/50 Ethylene-Glycol & Water Mix
Engine Oil (2)	
Temperatures Above 0°F (-18°C)	SAE 10W-30 API SH/CD ECII
Temperatures Below 32°F (0°C)	SAE 5W-30 API SH/CD ECII
Front Axle (3)	SAE 80W-90 API GL-5 (MIL-L-2105C)
Rear Axle	SAE 80W-90 API GL-5 (MIL-L-2105C)
Rear Axle (Trac-Lok) (4)	SAE 80W-140 API GL-5
Rear Axle (Trailer Towing) (5)	SAE 75W-140 Synthetic
Hydraulic Clutch	DOT 3 (SAE J-1703F) Brake Fluid
Manual Transmission	SAE 75W-90 API GL-5
Manual Steering Box	Multi-Purpose NLGI Grade 2EP
Power Steering Pump	Power Steering Fluid
Transfer Case	Dexron-IIIE ATF
Parking Brake Cable Guides	NLGI Grade 2, GC-LB
Brake Caliper Bushings	GE 661 or DOW 111 Silicone Grease
Caliper Slide Pins	GE 661 or DOW 111 Silicone Grease
Door & Hood Hinges	Light Engine Oil
Wheel Bearings	Multi-Purpose NLGI Grade 2EP, GC-LB

Drive Shaft U-Joints ..... Multi-Purpose NLGI Grade 2EP, GC-LB  
 Steering Linkage (6)(7) .... Multi-Purpose NLGI Grade 2EP, GC-LB  
 Ball Joints (6)(8) ..... Multi-Purpose NLGI Grade 2EP, GC-LB  
 Weatherstrip ..... Silicone Spray Lubricant  
 Wheel Lug Nut Torque ..... 80-110 ft. lbs. (115-145 N.m)

- (1) - DO NOT use Dexron-II ATF, Clutch chatter can result.
- (2) - SAE 10W-30 SH/CD is preferred.
- (3) - DO NOT use heavier weight lubricant, as it will cause axle engagement difficulties, use only SAE 80W-90 lube.
- (4) - Add 4 ozs. (118 ml) of Limited-Slip differential lubricant additive when changing fluid.
- (5) - For vehicles operating under heavy-duty towing conditions, use SAE 75W-140 Synthetic lube.  
 NOTE: Before using SAE 75W-140 Synthetic, old fluid must be DRAINED and FLUSHED with clean mineral based (non-synthetic) axle lubricant. Then refill with new synthetic lube.
- (6) - Use low pressure grease gun to prevent seal damage.
- (7) - Fill until lubricant squeezes out from the base of seals.
- (8) - Fill ball joint until seal starts to swell.

Fluid Capacities

Application	(1) Quantity
Cooling System	
2.5L (2) .....	10.0 Qts. (9.5L)
4.0L (3) .....	12.0 Qts. (11.4L)
Engine Oil (4)	
2.5L .....	4.0 Qts. (3.8L)
4.0L .....	6.0 Qts. (5.7L)

- (1) - Capacities are recommended or calculated levels. Always use dipstick (if available) to measure level.
- (2) - Includes 2.3 qts. (2.2L) for coolant recovery bottle.
- (3) - Includes 1.0 qt. (0.9L) for coolant recovery bottle.
- (4) - Includes Filter.

**52,500 MILE (84,000 KM) SERVICE**

52,500 MILE (84,000 KM) SERVICE

Service Or Inspect
Verify Last Major Service Was Performed
Check Fluid Levels
Check Fuel Lines, Connections
Check Cooling System Hoses and Clamps
Check Exhaust System & Heat Shielding
Inspect Brake System
Inspect Underside of Vehicle (Bolts & Threaded Fasteners)
Inspect C/V Joint boots (4WD)
Check Drive Shaft Seals

Lubricate Ball Joints, Steering Linkage & Suspension
Lube Drive Shaft U-Joints and Slip Splines
Lube Front Axle Drive Joint and Pivot Bearings (4WD)
Check/Lube Manual Steering Gear
Rotate Tires and Adjust Air Pressure (Including Spare)
Replace
Engine Oil
Oil Filter
Flush and Fill Engine Coolant, if not done in last 36 months

Lubrication Specifications

Application	Specification
Automatic Transmission	
30RH (3-Speed) (1)	Mopar 7176 ATF PLUS
AW4 (4-Speed)	Dexron-IIIE/Mercon ATF
Brake Master Cylinder	DOT 3 (SAE J-1703F) Brake Fluid
Engine Coolant	50/50 Ethylene-Glycol & Water Mix
Engine Oil (2)	
Temperatures Above 0°F (-18°C)	SAE 10W-30 API SH/CD ECII
Temperatures Below 32°F (0°C)	SAE 5W-30 API SH/CD ECII
Front Axle (3)	SAE 80W-90 API GL-5 (MIL-L-2105C)
Rear Axle	SAE 80W-90 API GL-5 (MIL-L-2105C)
Rear Axle (Trac-Lok) (4)	SAE 80W-140 API GL-5
Rear Axle (Trailer Towing) (5)	SAE 75W-140 Synthetic
Hydraulic Clutch	DOT 3 (SAE J-1703F) Brake Fluid
Manual Transmission	SAE 75W-90 API GL-5
Manual Steering Box	Multi-Purpose NLGI Grade 2EP
Power Steering Pump	Power Steering Fluid
Transfer Case	Dexron-IIIE ATF
Parking Brake Cable Guides	NLGI Grade 2, GC-LB
Brake Caliper Bushings	GE 661 or DOW 111 Silicone Grease
Caliper Slide Pins	GE 661 or DOW 111 Silicone Grease
Door & Hood Hinges	Light Engine Oil
Wheel Bearings	Multi-Purpose NLGI Grade 2EP, GC-LB
Drive Shaft U-Joints	Multi-Purpose NLGI Grade 2EP, GC-LB
Steering Linkage (6)(7)	Multi-Purpose NLGI Grade 2EP, GC-LB
Ball Joints (6)(8)	Multi-Purpose NLGI Grade 2EP, GC-LB
Weatherstrip	Silicone Spray Lubricant
Wheel Lug Nut Torque	80-110 ft. lbs. (115-145 N.m)
(1) - DO NOT use Dexron-II ATF, Clutch chatter can result.	
(2) - SAE 10W-30 SH/CD is preferred.	
(3) - DO NOT use heavier weight lubricant, as it will cause axle engagement difficulties, use only SAE 80W-90 lube.	
(4) - Add 4 ozs. (118 ml) of Limited-Slip differential lubricant additive when changing fluid.	
(5) - For vehicles operating under heavy-duty towing conditions, use SAE 75W-140 Synthetic lube.	
NOTE: Before using SAE 75W-140 Synthetic, old fluid must be DRAINED and FLUSHED with clean mineral based (non-synthetic) axle lubricant. Then refill with new synthetic lube.	
(6) - Use low pressure grease gun to prevent seal damage.	

- (7) - Fill until lubricant squeezes out from the base of seals.
- (8) - Fill ball joint until seal starts to swell.

Fluid Capacities

Application	(1) Quantity
Cooling System	
2.5L (2) .....	10.0 Qts. (9.5L)
4.0L (3) .....	12.0 Qts. (11.4L)
Engine Oil (4)	
2.5L .....	4.0 Qts. (3.8L)
4.0L .....	6.0 Qts. (5.7L)

- (1) - Capacities are recommended or calculated levels. Always use dipstick (if available) to measure level.
- (2) - Includes 2.3 qts. (2.2L) for coolant recovery bottle.
- (3) - Includes 1.0 qt. (0.9L) for coolant recovery bottle.
- (4) - Includes Filter.

### 60,000 MILE (96,000 KM) SERVICE

#### 60,000 MILE (96,000 KM) SERVICE

Service Or Inspect
Verify Last Major Service Was Performed
Check Fluid Levels
Check Cooling System Hoses and Clamps
Check Coolant Strength
Check/Adjust Accessory Drive Belts
Ignition Timing
Clean EGR Passages (if equipped)
Check Exhaust System & Heat Shielding
Clean/Inspect Battery and Battery Terminals
Inspect Brake System
Inspect Exhaust System
Inspect Underside of Vehicle (Bolts & Threaded Fasteners)
Inspect C/V Joint boots (4WD)
Check Drive Shaft Seals
Lubricate Ball Joints, Steering Linkage & Suspension
Lube Drive Shaft U-Joints and Slip Splines
Lube Front Axle Drive Joint and Pivot Bearings (4WD)
Check/Lube Manual Steering Gear

Suspension Bushings, Springs, Arms & Rear Jounce Bumpers
Parking Brake System
Inspect Shocks for Leakage
Inspect Tire Wear Pattern
Rotate Tires and Adjust Air Pressure (Including Spare)
Replace
Engine Oil
Oil Filter
Spark Plugs
Ignition Cables
Distributor Cap and Rotor
Air Filter Element
EGR Valve & Tube (1989-92)
Emission System Vacuum Hoses
Vacuum Operated Emission Components (1989-92)
PCV Valve (1)
Drive Belt (V-Type) (2)
Accessory Drive Belts
Fuel Filter (In-Line)
Flush and Fill Engine Coolant, if not done in last 24 months
Automatic Transmission Fluid, Filter and Adjust Bands
Transfer Case (Drain and Refill)
Front & Rear Axle Fluid

- (1) - Replacement is recommended by Chrysler at this time, but it is not required to maintain the warranty on the PCV valve.
- (2) - Check and replace as needed.

Lubrication Specifications

Application	Specification
Automatic Transmission	
30RH (3-Speed) (1)	Mopar 7176 ATF PLUS
AW4 (4-Speed)	Dexron-IIIE/Mercon ATF
Brake Master Cylinder	DOT 3 (SAE J-1703F) Brake Fluid
Engine Coolant	50/50 Ethylene-Glycol & Water Mix
Engine Oil (2)	
Temperatures Above 0°F (-18°C)	SAE 10W-30 API SH/CD ECII
Temperatures Below 32°F (0°C)	SAE 5W-30 API SH/CD ECII

Front Axle (3)	SAE 80W-90 API GL-5 (MIL-L-2105C)
Rear Axle	SAE 80W-90 API GL-5 (MIL-L-2105C)
Rear Axle (Trac-Lok) (4)	SAE 80W-140 API GL-5
Rear Axle (Trailer Towing) (5)	SAE 75W-140 Synthetic
Hydraulic Clutch	DOT 3 (SAE J-1703F) Brake Fluid
Manual Transmission	SAE 75W-90 API GL-5
Manual Steering Box	Multi-Purpose NLGI Grade 2EP
Power Steering Pump	Power Steering Fluid
Transfer Case	Dexron-II E ATF
Parking Brake Cable Guides	NLGI Grade 2, GC-LB
Brake Caliper Bushings	GE 661 or DOW 111 Silicone Grease
Caliper Slide Pins	GE 661 or DOW 111 Silicone Grease
Door & Hood Hinges	Light Engine Oil
Wheel Bearings	Multi-Purpose NLGI Grade 2EP, GC-LB
Drive Shaft U-Joints	Multi-Purpose NLGI Grade 2EP, GC-LB
Steering Linkage (6) (7)	Multi-Purpose NLGI Grade 2EP, GC-LB
Ball Joints (6) (8)	Multi-Purpose NLGI Grade 2EP, GC-LB
Weatherstrip	Silicone Spray Lubricant
Wheel Lug Nut Torque	80-110 ft. lbs. (115-145 N.m)

- (1) - DO NOT use Dexron-II ATF, Clutch chatter can result.
- (2) - SAE 10W-30 SH/CD is preferred.
- (3) - DO NOT use heavier weight lubricant, as it will cause axle engagement difficulties, use only SAE 80W-90 lube.
- (4) - Add 4 ozs. (118 ml) of Limited-Slip differential lubricant additive when changing fluid.
- (5) - For vehicles operating under heavy-duty towing conditions, use SAE 75W-140 Synthetic lube.  
NOTE: Before using SAE 75W-140 Synthetic, old fluid must be DRAINED and FLUSHED with clean mineral based (non-synthetic) axle lubricant. Then refill with new synthetic lube.
- (6) - Use low pressure grease gun to prevent seal damage.
- (7) - Fill until lubricant squeezes out from the base of seals.
- (8) - Fill ball joint until seal starts to swell.

### Fluid Capacities

Application	(1) Quantity
Automatic Transmission (2)	
30RH (3-Speed)	
Fluid Change	4.0 Qts. (3.8L)
Overhaul (Dry Fill)	8.75 Qts. (8.2L)
AW4 (4-Speed)	
Fluid Change	2.0 Qts. (1.7L)
Overhaul (Dry Fill)	8.5 Qts. (8.0L)
Cooling System	
2.5L (3)	10.0 Qts. (9.5L)
4.0L (4)	12.0 Qts. (11.4L)
Engine Oil (5)	
2.5L	4.0 Qts. (3.8L)
4.0L	6.0 Qts. (5.7L)
Manual Transmission (6)	
AX4 (4-Speed AISIN)	7.4 Pts. (3.5L)
T4 (Borg-Warner)	3.9 Pts. (1.8L)
AX5 (5-Speed AISIN)	
2.5L (2WD)	7.0 Pts. (3.5L)
2.5L (4X4)	6.6 Pts. (3.2L)
T5 (Borg-Warner)	4.5 Pts. (2.1L)
AX15 (5-Speed AISIN)	
4.0L (2WD)	6.4 Pts. (3.1L)
4.0L (4X4)	6.5 Pts. (3.15L)
Transfer Case	



Command-Trac (NV 231) .....	2.2 Pts. (1.0L)
Selec-Trac (NV 242) .....	3.0 Pts. (1.4L)
Drive Axles (6)	
Front Axle (Model 30)	
Command-Trac (Disconnect) .....	3.76 Pts. (1.65L)
(Disconnect Housing) (7) .....	5.0 Ozs. (0.15L)
Selec-Trac (Non-Disconnect) .....	3.13 Pts. (1.5L)
Rear Axle	
1989-94 (8) .....	2.5 Pts. (1.2L)
1995-96	
Model 35 (8) .....	3.5 Pts. (1.6L)
8-1/4" (8) .....	4.4 Pts. (2.1L)

- (1) - Capacities are recommended or calculated levels. Always use dipstick (if available) to measure level.
- (2) - Total quantity required will vary, after adding amount shown check dipstick and fill to proper level.
- (3) - Includes 2.3 qts. (2.2L) for coolant recovery bottle.
- (4) - Includes 1.0 qt. (0.9L) for coolant recovery bottle.
- (5) - Includes Filter.
- (6) - Fill to bottom edge of filler plug hole.
- (7) - Add 5 ozs. of gear lubricant through indicator switch hole.
- (8) - If equipped with TRAC-LOK, add 4 ozs. of Limited-Slip differential lubricant additive first, then add new fluid.

Service Labor Times

Application	(1) Hours
1989-92	
2.5L	
Automatic Transmission .....	9.3
Manual Transmission .....	7.5
4.0L	
Automatic Transmission .....	10.1
Manual Transmission .....	8.3
1993-96	
2.5L	
Automatic Transmission .....	7.6
Manual Transmission .....	5.8
4.0L	
Automatic Transmission .....	7.8
Manual Transmission .....	6.0

- (1) - Add .6 hour for vehicles equipped with 4WD.

**67,500 MILE (108,000 KM) SERVICE**

67,500 MILE (108,000 KM) SERVICE

Service Or Inspect
Verify Last Major Service Was Performed
Check Fluid Levels
Check Cooling System Hoses and Clamps
Check Exhaust System & Heat Shielding
Inspect Underside of Vehicle (Bolts & Threaded Fasteners)

Inspect C/V Joint boots (4WD)
Check Drive Shaft Seals
Lubricate Ball Joints, Steering Linkage & Suspension
Lube Drive Shaft U-Joints and Slip Splines
Lube Front Axle Drive Joint and Pivot Bearings (4WD)
Check/Lube Manual Steering Gear
Lube Parking Brake Ratio Lever Pivot
Lube Manual Gearshift Control (4WD Transfer Case)
Inspect Front Brake Pads & Rotors
Inspect Rear Brake Linings & Drums
Inspect Brake System Hoses & Lines
Inspect Shocks for Leakage
Inspect Tire Wear Pattern
Rotate Tires and Adjust Air Pressure (Including Spare)
Replace
Engine Oil
Oil Filter

Lubrication Specifications

Application	Specification
Automatic Transmission	
30RH (3-Speed) (1)	Mopar 7176 ATF PLUS
AW4 (4-Speed)	Dexron-IIIE/Mercon ATF
Brake Master Cylinder	DOT 3 (SAE J-1703F) Brake Fluid
Engine Coolant	50/50 Ethylene-Glycol & Water Mix
Engine Oil (2)	
Temperatures Above 0°F (-18°C)	SAE 10W-30 API SH/CD ECII
Temperatures Below 32°F (0°C)	SAE 5W-30 API SH/CD ECII
Front Axle (3)	SAE 80W-90 API GL-5 (MIL-L-2105C)
Rear Axle	SAE 80W-90 API GL-5 (MIL-L-2105C)
Rear Axle (Trac-Lok) (4)	SAE 80W-140 API GL-5
Rear Axle (Trailer Towing) (5)	SAE 75W-140 Synthetic
Hydraulic Clutch	DOT 3 (SAE J-1703F) Brake Fluid
Manual Transmission	SAE 75W-90 API GL-5
Manual Steering Box	Multi-Purpose NLGI Grade 2EP
Power Steering Pump	Power Steering Fluid
Transfer Case	Dexron-IIIE ATF
Parking Brake Cable Guides	NLGI Grade 2, GC-LB
Brake Caliper Bushings	GE 661 or DOW 111 Silicone Grease
Caliper Slide Pins	GE 661 or DOW 111 Silicone Grease
Door & Hood Hinges	Light Engine Oil
Wheel Bearings	Multi-Purpose NLGI Grade 2EP, GC-LB
Drive Shaft U-Joints	Multi-Purpose NLGI Grade 2EP, GC-LB
Steering Linkage (6)(7)	Multi-Purpose NLGI Grade 2EP, GC-LB

Ball Joints (6) (8) ..... Multi-Purpose NLGI Grade 2EP, GC-LB  
 Weatherstrip ..... Silicone Spray Lubricant  
 Wheel Lug Nut Torque ..... 80-110 ft. lbs. (115-145 N.m)

- (1) - DO NOT use Dexron-II ATF, Clutch chatter can result.
- (2) - SAE 10W-30 SH/CD is preferred.
- (3) - DO NOT use heavier weight lubricant, as it will cause axle engagement difficulties, use only SAE 80W-90 lube.
- (4) - Add 4 ozs. (118 ml) of Limited-Slip differential lubricant additive when changing fluid.
- (5) - For vehicles operating under heavy-duty towing conditions, use SAE 75W-140 Synthetic lube.  
 NOTE: Before using SAE 75W-140 Synthetic, old fluid must be DRAINED and FLUSHED with clean mineral based (non-synthetic) axle lubricant. Then refill with new synthetic lube.
- (6) - Use low pressure grease gun to prevent seal damage.
- (7) - Fill until lubricant squeezes out from the base of seals.
- (8) - Fill ball joint until seal starts to swell.

Fluid Capacities

Application	(1) Quantity
Cooling System	
2.5L (2) .....	10.0 Qts. (9.5L)
4.0L (3) .....	12.0 Qts. (11.4L)
Engine Oil (4)	
2.5L .....	4.0 Qts. (3.8L)
4.0L .....	6.0 Qts. (5.7L)

- (1) - Capacities are recommended or calculated levels. Always use dipstick (if available) to measure level.
- (2) - Includes 2.3 qts. (2.2L) for coolant recovery bottle.
- (3) - Includes 1.0 qt. (0.9L) for coolant recovery bottle.
- (4) - Includes Filter.

**75,000 MILE (120,000 KM) SERVICE**

75,000 MILE (120,000 KM) SERVICE

Service Or Inspect
Verify Last Major Service Was Performed
Check Fluid Levels
Check Fuel Lines, Connections
Check Cooling System Hoses and Clamps
Check Coolant Strength
Check Exhaust System & Heat Shielding
Clean Battery and Battery Terminals
Inspect Brake System
Check Operation of Horn, Wipers/Washers & All Exterior Lights
Inspect Condition of Wiper Blades

Check Headlight Alignment
Check Seat Belt Webbing and Release Mechanisms
Check Parking Brake Operation
Check Shift/Clutch Interlock Operation
Inspect Underside of Vehicle (Bolts & Threaded Fasteners)
Inspect C/V Joint boots (4WD)
Check Drive Shaft Seals
Lubricate Ball Joints, Steering Linkage & Suspension
Lube Drive Shaft U-Joints and Slip Splines
Lube Front Axle Drive Joint and Pivot Bearings (4WD)
Check/Lube Manual Steering Gear
Lubricate Weatherstripping with Silicone
Lubricate Door Hinges
Lubricate Door Locks
Check Body Drain Holes
Rotate Tires and Adjust Air Pressure
Replace
Engine Oil
Oil Filter
Manual Transmission Fluid
Flush and Fill Engine Coolant, if not done in last 24 months

Lubrication Specifications

Application	Specification
Automatic Transmission	
30RH (3-Speed) (1)	Mopar 7176 ATF PLUS
AW4 (4-Speed)	Dexron-IIIE/Mercon ATF
Brake Master Cylinder	DOT 3 (SAE J-1703F) Brake Fluid
Engine Coolant	50/50 Ethylene-Glycol & Water Mix
Engine Oil (2)	
Temperatures Above 0°F (-18°C)	SAE 10W-30 API SH/CD ECII
Temperatures Below 32°F (0°C)	SAE 5W-30 API SH/CD ECII
Front Axle (3)	SAE 80W-90 API GL-5 (MIL-L-2105C)
Rear Axle	SAE 80W-90 API GL-5 (MIL-L-2105C)
Rear Axle (Trac-Lok) (4)	SAE 80W-140 API GL-5
Rear Axle (Trailer Towing) (5)	SAE 75W-140 Synthetic
Hydraulic Clutch	DOT 3 (SAE J-1703F) Brake Fluid
Manual Transmission	SAE 75W-90 API GL-5
Manual Steering Box	Multi-Purpose NLGI Grade 2EP
Power Steering Pump	Power Steering Fluid

Transfer Case ..... Dexron-II E ATF  
 Parking Brake Cable Guides ..... NLGI Grade 2, GC-LB  
 Brake Caliper Bushings ..... GE 661 or DOW 111 Silicone Grease  
 Caliper Slide Pins ..... GE 661 or DOW 111 Silicone Grease  
 Door & Hood Hinges ..... Light Engine Oil  
 Wheel Bearings ..... Multi-Purpose NLGI Grade 2EP, GC-LB  
 Drive Shaft U-Joints ..... Multi-Purpose NLGI Grade 2EP, GC-LB  
 Steering Linkage (6) (7) .... Multi-Purpose NLGI Grade 2EP, GC-LB  
 Ball Joints (6) (8) ..... Multi-Purpose NLGI Grade 2EP, GC-LB  
 Weatherstrip ..... Silicone Spray Lubricant  
 Wheel Lug Nut Torque ..... 80-110 ft. lbs. (115-145 N.m)

- (1) - DO NOT use Dexron-II ATF, Clutch chatter can result.
- (2) - SAE 10W-30 SH/CD is preferred.
- (3) - DO NOT use heavier weight lubricant, as it will cause axle engagement difficulties, use only SAE 80W-90 lube.
- (4) - Add 4 ozs. (118 ml) of Limited-Slip differential lubricant additive when changing fluid.
- (5) - For vehicles operating under heavy-duty towing conditions, use SAE 75W-140 Synthetic lube.  
 NOTE: Before using SAE 75W-140 Synthetic, old fluid must be DRAINED and FLUSHED with clean mineral based (non-synthetic) axle lubricant. Then refill with new synthetic lube.
- (6) - Use low pressure grease gun to prevent seal damage.
- (7) - Fill until lubricant squeezes out from the base of seals.
- (8) - Fill ball joint until seal starts to swell.

#### Fluid Capacities

Application	(1) Quantity
Automatic Transmission (2)	
30RH (3-Speed)	
Fluid Change .....	4.0 Qts. (3.8L)
Overhaul (Dry Fill) .....	8.75 Qts. (8.2L)
AW4 (4-Speed)	
Fluid Change .....	2.0 Qts. (1.7L)
Overhaul (Dry Fill) .....	8.5 Qts. (8.0L)
Cooling System	
2.5L (3) .....	10.0 Qts. (9.5L)
4.0L (4) .....	12.0 Qts. (11.4L)
Engine Oil (5)	
2.5L .....	4.0 Qts. (3.8L)
4.0L .....	6.0 Qts. (5.7L)
Manual Transmission (6)	
AX4 (4-Speed AISIN) .....	7.4 Pts. (3.5L)
T4 (Borg-Warner) .....	3.9 Pts. (1.8L)
AX5 (5-Speed AISIN)	
2.5L (2WD) .....	7.0 Pts. (3.5L)
2.5L (4X4) .....	6.6 Pts. (3.2L)
T5 (Borg-Warner) .....	4.5 Pts. (2.1L)
AX15 (5-Speed AISIN)	
4.0L (2WD) .....	6.4 Pts. (3.1L)
4.0L (4X4) .....	6.5 Pts. (3.15L)
Transfer Case	
Command-Trac (NV 231) .....	2.2 Pts. (1.0L)
Selec-Trac (NV 242) .....	3.0 Pts. (1.4L)
Drive Axles (6)	
Front Axle (Model 30)	
Command-Trac (Disconnect) .....	3.76 Pts. (1.65L)
(Disconnect Housing) (7) .....	5.0 Ozs. (0.15L)
Selec-Trac (Non-Disconnect) .....	3.13 Pts. (1.5L)
Rear Axle	

1989-94 (8) .....	2.5 Pts. (1.2L)
1995-96	
Model 35 (8) .....	3.5 Pts. (1.6L)
8-1/4" (8) .....	4.4 Pts. (2.1L)

- (1) - Capacities are recommended or calculated levels. Always use dipstick (if available) to measure level.
- (2) - Total quantity required will vary, after adding amount shown check dipstick and fill to proper level.
- (3) - Includes 2.3 qts. (2.2L) for coolant recovery bottle.
- (4) - Includes 1.0 qt. (0.9L) for coolant recovery bottle.
- (5) - Includes Filter.
- (6) - Fill to bottom edge of filler plug hole.
- (7) - Add 5 ozs. of gear lubricant through indicator switch hole.
- (8) - If equipped with TRAC-LOK, add 4 ozs. of Limited-Slip differential lubricant additive first, then add new fluid.

### 82,500 MILE (132,000 KM) SERVICE

#### 82,500 MILE (132,000 KM) SERVICE

Service Or Inspect	
	Verify Last Major Service Was Performed
	Check Fluid Levels
	Check Cooling System Hoses and Clamps
	Check Exhaust System & Heat Shielding
	Inspect Brake System
	Inspect Underside of Vehicle (Bolts & Threaded Fasteners)
	Inspect C/V Joint boots (4WD)
	Check Drive Shaft Seals
	Lubricate Ball Joints, Steering Linkage & Suspension
	Lube Drive Shaft U-Joints and Slip Splines
	Lube Front Axle Drive Joint and Pivot Bearings (4WD)
	Check/Lube Manual Steering Gear
	Rotate Tires and Adjust Air Pressure (Including Spare)
Replace	
	Engine Oil
	Oil Filter
	O2 Sensor (1989)
	Flush and Fill Engine Coolant, if not done in last 24 months
Lubrication Specifications	

Application	Specification
Automatic Transmission	
30RH (3-Speed) (1)	Mopar 7176 ATF PLUS
AW4 (4-Speed)	Dexron-IIIE/Mercon ATF
Brake Master Cylinder	DOT 3 (SAE J-1703F) Brake Fluid
Engine Coolant	50/50 Ethylene-Glycol & Water Mix
Engine Oil (2)	
Temperatures Above 0°F (-18°C)	SAE 10W-30 API SH/CD ECII
Temperatures Below 32°F (0°C)	SAE 5W-30 API SH/CD ECII
Front Axle (3)	SAE 80W-90 API GL-5 (MIL-L-2105C)
Rear Axle	SAE 80W-90 API GL-5 (MIL-L-2105C)
Rear Axle (Trac-Lok) (4)	SAE 80W-140 API GL-5
Rear Axle (Trailer Towing) (5)	SAE 75W-140 Synthetic
Hydraulic Clutch	DOT 3 (SAE J-1703F) Brake Fluid
Manual Transmission	SAE 75W-90 API GL-5
Manual Steering Box	Multi-Purpose NLGI Grade 2EP
Power Steering Pump	Power Steering Fluid
Transfer Case	Dexron-IIIE ATF
Parking Brake Cable Guides	NLGI Grade 2, GC-LB
Brake Caliper Bushings	GE 661 or DOW 111 Silicone Grease
Caliper Slide Pins	GE 661 or DOW 111 Silicone Grease
Door & Hood Hinges	Light Engine Oil
Wheel Bearings	Multi-Purpose NLGI Grade 2EP, GC-LB
Drive Shaft U-Joints	Multi-Purpose NLGI Grade 2EP, GC-LB
Steering Linkage (6) (7)	Multi-Purpose NLGI Grade 2EP, GC-LB
Ball Joints (6) (8)	Multi-Purpose NLGI Grade 2EP, GC-LB
Weatherstrip	Silicone Spray Lubricant
Wheel Lug Nut Torque	80-110 ft. lbs. (115-145 N.m)

- (1) - DO NOT use Dexron-II ATF, Clutch chatter can result.
- (2) - SAE 10W-30 SH/CD is preferred.
- (3) - DO NOT use heavier weight lubricant, as it will cause axle engagement difficulties, use only SAE 80W-90 lube.
- (4) - Add 4 ozs. (118 ml) of Limited-Slip differential lubricant additive when changing fluid.
- (5) - For vehicles operating under heavy-duty towing conditions, use SAE 75W-140 Synthetic lube.  
NOTE: Before using SAE 75W-140 Synthetic, old fluid must be DRAINED and FLUSHED with clean mineral based (non-synthetic) axle lubricant. Then refill with new synthetic lube.
- (6) - Use low pressure grease gun to prevent seal damage.
- (7) - Fill until lubricant squeezes out from the base of seals.
- (8) - Fill ball joint until seal starts to swell.

#### Fluid Capacities

Application	(1) Quantity
Cooling System	
2.5L (2)	10.0 Qts. (9.5L)
4.0L (3)	12.0 Qts. (11.4L)
Engine Oil (4)	
2.5L	4.0 Qts. (3.8L)
4.0L	6.0 Qts. (5.7L)

- (1) - Capacities are recommended or calculated levels. Always use dipstick (if available) to measure level.
- (2) - Includes 2.3 qts. (2.2L) for coolant recovery bottle.
- (3) - Includes 1.0 qt. (0.9L) for coolant recovery bottle.
- (4) - Includes Filter.

## 90,000 MILE (144,000 KM) SERVICE

90,000 MILE (144,000 KM) SERVICE

Service Or Inspect
Verify Last Major Service Was Performed
Check Fluid Levels
Check Fuel Lines, Connections
Check Cooling System Hoses and Clamps
Check Coolant Strength
Clean Battery and Battery Terminals
Check/Adjust Accessory Drive Belt Tension
Check Exhaust System & Heat Shielding
Check Operation of Horn, Wipers/Washers & All Exterior Lights
Inspect Condition of Wiper Blades
Check Headlight Alignment
Check Seat Belt Webbing and Release Mechanisms
Check Parking Brake Operation
Check Shift/Clutch Interlock Operation
Inspect Underside of Vehicle (Bolts & Threaded Fasteners)
Inspect C/V Joint boots (4WD)
Check Drive Shaft Seals
Lubricate Ball Joints, Steering Linkage & Suspension
Lube Drive Shaft U-Joints and Slip Splines
Lube Front Axle Drive Joint and Pivot Bearings (4WD)
Check/Lube Manual Steering Gear
Lube Parking Brake Ratio Lever Pivot
Lube Manual Gearshift Control (4WD Transfer Case)
Inspect Front Brake Pads & Rotors
Inspect Rear Brake Linings & Drums
Inspect Brake System Hoses & Lines
Inspect Shocks for Leakage
Inspect Tire Wear Pattern



Lubricate Weatherstripping with Silicone
Lubricate Door Hinges
Lubricate Door Locks
Check Body Drain Holes
Rotate Tires and Adjust Air Pressure
Replace
Engine Oil
Oil Filter
Air Filter Element
Spark Plugs
Automatic Transmission Fluid, Filter and Adjust Bands
PCV Valve (1) (2)
Drive Belt (V-Type) (2) (3)

- (1) - Replacement is recommended by Chrysler at this time, but it is not required to maintain the warranty on the PCV valve.  
(2) - Not required, if belt or PCV Valve was previously replaced  
(3) - Check and replace as needed.

Lubrication Specifications

Application	Specification
Automatic Transmission	
30RH (3-Speed) (1)	Mopar 7176 ATF PLUS
AW4 (4-Speed)	Dexron-IIIE/Mercon ATF
Brake Master Cylinder	DOT 3 (SAE J-1703F) Brake Fluid
Engine Coolant	50/50 Ethylene-Glycol & Water Mix
Engine Oil (2)	
Temperatures Above 0°F (-18°C)	SAE 10W-30 API SH/CD ECII
Temperatures Below 32°F (0°C)	SAE 5W-30 API SH/CD ECII
Front Axle (3)	SAE 80W-90 API GL-5 (MIL-L-2105C)
Rear Axle	SAE 80W-90 API GL-5 (MIL-L-2105C)
Rear Axle (Trac-Lok) (4)	SAE 80W-140 API GL-5
Rear Axle (Trailer Towing) (5)	SAE 75W-140 Synthetic
Hydraulic Clutch	DOT 3 (SAE J-1703F) Brake Fluid
Manual Transmission	SAE 75W-90 API GL-5
Manual Steering Box	Multi-Purpose NLGI Grade 2EP
Power Steering Pump	Power Steering Fluid
Transfer Case	Dexron-IIIE ATF
Parking Brake Cable Guides	NLGI Grade 2, GC-LB
Brake Caliper Bushings	GE 661 or DOW 111 Silicone Grease
Caliper Slide Pins	GE 661 or DOW 111 Silicone Grease
Door & Hood Hinges	Light Engine Oil
Wheel Bearings	Multi-Purpose NLGI Grade 2EP, GC-LB
Drive Shaft U-Joints	Multi-Purpose NLGI Grade 2EP, GC-LB
Steering Linkage (6)(7)	Multi-Purpose NLGI Grade 2EP, GC-LB
Ball Joints (6)(8)	Multi-Purpose NLGI Grade 2EP, GC-LB
Weatherstrip	Silicone Spray Lubricant
Wheel Lug Nut Torque	80-110 ft. lbs. (115-145 N.m)

- (1) - DO NOT use Dexron-II ATF, Clutch chatter can result.
- (2) - SAE 10W-30 SH/CD is preferred.
- (3) - DO NOT use heavier weight lubricant, as it will cause axle engagement difficulties, use only SAE 80W-90 lube.
- (4) - Add 4 ozs. (118 ml) of Limited-Slip differential lubricant additive when changing fluid.
- (5) - For vehicles operating under heavy-duty towing conditions, use SAE 75W-140 Synthetic lube.  
NOTE: Before using SAE 75W-140 Synthetic, old fluid must be DRAINED and FLUSHED with clean mineral based (non-synthetic) axle lubricant. Then refill with new synthetic lube.
- (6) - Use low pressure grease gun to prevent seal damage.
- (7) - Fill until lubricant squeezes out from the base of seals.
- (8) - Fill ball joint until seal starts to swell.

### Fluid Capacities

Application	(1) Quantity
Automatic Transmission (2)	
30RH (3-Speed)	
Fluid Change .....	4.0 Qts. (3.8L)
Overhaul (Dry Fill) .....	8.75 Qts. (8.2L)
AW4 (4-Speed)	
Fluid Change .....	2.0 Qts. (1.7L)
Overhaul (Dry Fill) .....	8.5 Qts. (8.0L)
Cooling System	
2.5L (3) .....	10.0 Qts. (9.5L)
4.0L (4) .....	12.0 Qts. (11.4L)
Engine Oil (5)	
2.5L .....	4.0 Qts. (3.8L)
4.0L .....	6.0 Qts. (5.7L)
Manual Transmission (6)	
AX4 (4-Speed AISIN) .....	7.4 Pts. (3.5L)
T4 (Borg-Warner) .....	3.9 Pts. (1.8L)
AX5 (5-Speed AISIN)	
2.5L (2WD) .....	7.0 Pts. (3.5L)
2.5L (4X4) .....	6.6 Pts. (3.2L)
T5 (Borg-Warner) .....	4.5 Pts. (2.1L)
AX15 (5-Speed AISIN)	
4.0L (2WD) .....	6.4 Pts. (3.1L)
4.0L (4X4) .....	6.5 Pts. (3.15L)
Transfer Case	
Command-Trac (NV 231) .....	2.2 Pts. (1.0L)
Selec-Trac (NV 242) .....	3.0 Pts. (1.4L)
Drive Axles (6)	
Front Axle (Model 30)	
Command-Trac (Disconnect) .....	3.76 Pts. (1.65L)
(Disconnect Housing) (7) .....	5.0 Ozs. (0.15L)
Selec-Trac (Non-Disconnect) .....	3.13 Pts. (1.5L)
Rear Axle	
1989-94 (8) .....	2.5 Pts. (1.2L)
1995-96	
Model 35 (8) .....	3.5 Pts. (1.6L)
8-1/4" (8) .....	4.4 Pts. (2.1L)

- (1) - Capacities are recommended or calculated levels. Always use dipstick (if available) to measure level.
- (2) - Total quantity required will vary, after adding amount shown check dipstick and fill to proper level.
- (3) - Includes 2.3 qts. (2.2L) for coolant recovery bottle.
- (4) - Includes 1.0 qt. (0.9L) for coolant recovery bottle.
- (5) - Includes Filter.

- (6) - Fill to bottom edge of filler plug hole.
- (7) - Add 5 ozs. of gear lubricant through indicator switch hole.
- (8) - If equipped with TRAC-LOK, add 4 ozs. of Limited-Slip differential lubricant additive first, then add new fluid.

Service Labor Times

Application	(1) Hours
2.5L	
Automatic Transmission .....	4.2
Manual Transmission .....	2.4
4.0L	
Automatic Transmission .....	4.3
Manual Transmission .....	2.5

(1) - Add .6 hr. for vehicles equipped with 4WD.

**97,500 MILE (156,000 KM) SERVICE**

97,500 MILE (156,000 KM) SERVICE

Service Or Inspect	
	Verify Last Major Service Was Performed
	Check Fluid Levels
	Check Cooling System Hoses and Clamps
	Check Exhaust System & Heat Shielding
	Inspect Brake System
	Inspect Underside of Vehicle (Bolts & Threaded Fasteners)
	Inspect C/V Joint boots (4WD)
	Check Drive Shaft Seals
	Lubricate Ball Joints, Steering Linkage & Suspension
	Lube Drive Shaft U-Joints and Slip Splines
	Lube Front Axle Drive Joint and Pivot Bearings (4WD)
	Check/Lube Manual Steering Gear
	Rotate Tires and Adjust Air Pressure (Including Spare)
Replace	
	Engine Oil
	Oil Filter
Lubrication Specifications	
Application	Specification
Automatic Transmission	

30RH (3-Speed) (1) ..... Mopar 7176 ATF PLUS  
 AW4 (4-Speed) ..... Dexron-IIIE/Mercon ATF  
 Brake Master Cylinder ..... DOT 3 (SAE J-1703F) Brake Fluid  
 Engine Coolant ..... 50/50 Ethylene-Glycol & Water Mix  
 Engine Oil (2)  
 Temperatures Above 0°F (-18°C) ..... SAE 10W-30 API SH/CD ECII  
 Temperatures Below 32°F (0°C) ..... SAE 5W-30 API SH/CD ECII  
 Front Axle (3) ..... SAE 80W-90 API GL-5 (MIL-L-2105C)  
 Rear Axle ..... SAE 80W-90 API GL-5 (MIL-L-2105C)  
 Rear Axle (Trac-Lok) (4) ..... SAE 80W-140 API GL-5  
 Rear Axle (Trailer Towing) (5) ..... SAE 75W-140 Synthetic  
 Hydraulic Clutch ..... DOT 3 (SAE J-1703F) Brake Fluid  
 Manual Transmission ..... SAE 75W-90 API GL-5  
 Manual Steering Box ..... Multi-Purpose NLGI Grade 2EP  
 Power Steering Pump ..... Power Steering Fluid  
 Transfer Case ..... Dexron-IIIE ATF  
 Parking Brake Cable Guides ..... NLGI Grade 2, GC-LB  
 Brake Caliper Bushings ..... GE 661 or DOW 111 Silicone Grease  
 Caliper Slide Pins ..... GE 661 or DOW 111 Silicone Grease  
 Door & Hood Hinges ..... Light Engine Oil  
 Wheel Bearings ..... Multi-Purpose NLGI Grade 2EP, GC-LB  
 Drive Shaft U-Joints ..... Multi-Purpose NLGI Grade 2EP, GC-LB  
 Steering Linkage (6) (7) ..... Multi-Purpose NLGI Grade 2EP, GC-LB  
 Ball Joints (6) (8) ..... Multi-Purpose NLGI Grade 2EP, GC-LB  
 Weatherstrip ..... Silicone Spray Lubricant  
 Wheel Lug Nut Torque ..... 80-110 ft. lbs. (115-145 N.m)

- (1) - DO NOT use Dexron-II ATF, Clutch chatter can result.
- (2) - SAE 10W-30 SH/CD is preferred.
- (3) - DO NOT use heavier weight lubricant, as it will cause axle engagement difficulties, use only SAE 80W-90 lube.
- (4) - Add 4 ozs. (118 ml) of Limited-Slip differential lubricant additive when changing fluid.
- (5) - For vehicles operating under heavy-duty towing conditions, use SAE 75W-140 Synthetic lube.  
 NOTE: Before using SAE 75W-140 Synthetic, old fluid must be DRAINED and FLUSHED with clean mineral based (non-synthetic) axle lubricant. Then refill with new synthetic lube.
- (6) - Use low pressure grease gun to prevent seal damage.
- (7) - Fill until lubricant squeezes out from the base of seals.
- (8) - Fill ball joint until seal starts to swell.

Fluid Capacities

Application	(1) Quantity
Cooling System	
2.5L (2) .....	10.0 Qts. (9.5L)
4.0L (3) .....	12.0 Qts. (11.4L)
Engine Oil (4)	
2.5L .....	4.0 Qts. (3.8L)
4.0L .....	6.0 Qts. (5.7L)

- (1) - Capacities are recommended or calculated levels. Always use dipstick (if available) to measure level.
- (2) - Includes 2.3 qts. (2.2L) for coolant recovery bottle.
- (3) - Includes 1.0 qt. (0.9L) for coolant recovery bottle.
- (4) - Includes Filter.

**105,000 MILE (168,000 KM) SERVICE**

105,000 MILE (168,000 KM) SERVICE

Service Or Inspect	
	Verify Last Major Service Was Performed
	Check Fluid Levels
	Check Fuel Lines, Connections
	Check Cooling System Hoses and Clamps
	Check Coolant Strength
	Check Exhaust System & Heat Shielding
	Clean Battery and Battery Terminals
	Inspect Brake System
	Check Operation of Horn, Wipers/Washers & All Exterior Lights
	Inspect Condition of Wiper Blades
	Check Headlight Alignment
	Check Seat Belt Webbing and Release Mechanisms
	Check Parking Brake Operation
	Check Shift/Clutch Interlock Operation
	Inspect Underside of Vehicle (Bolts & Threaded Fasteners)
	Inspect C/V Joint boots (4WD)
	Check Drive Shaft Seals
	Lubricate Ball Joints, Steering Linkage & Suspension
	Lube Drive Shaft U-Joints and Slip Splines
	Lube Front Axle Drive Joint and Pivot Bearings (4WD)
	Check/Lube Manual Steering Gear
	Lubricate Weatherstripping with Silicone
	Lubricate Door Hinges
	Lubricate Door Locks
	Check Body Drain Holes
	Rotate Tires and Adjust Air Pressure
Replace	
	Engine Oil
	Oil Filter
	Flush and Fill Engine Coolant, if not done in last 24 months

## Lubrication Specifications

Application	Specification
Automatic Transmission	
30RH (3-Speed) (1)	Mopar 7176 ATF PLUS
AW4 (4-Speed)	Dexron-IIIE/Mercon ATF
Brake Master Cylinder	DOT 3 (SAE J-1703F) Brake Fluid
Engine Coolant	50/50 Ethylene-Glycol & Water Mix
Engine Oil (2)	
Temperatures Above 0°F (-18°C)	SAE 10W-30 API SH/CD ECII
Temperatures Below 32°F (0°C)	SAE 5W-30 API SH/CD ECII
Front Axle (3)	SAE 80W-90 API GL-5 (MIL-L-2105C)
Rear Axle	SAE 80W-90 API GL-5 (MIL-L-2105C)
Rear Axle (Trac-Lok) (4)	SAE 80W-140 API GL-5
Rear Axle (Trailer Towing) (5)	SAE 75W-140 Synthetic
Hydraulic Clutch	DOT 3 (SAE J-1703F) Brake Fluid
Manual Transmission	SAE 75W-90 API GL-5
Manual Steering Box	Multi-Purpose NLGI Grade 2EP
Power Steering Pump	Power Steering Fluid
Transfer Case	Dexron-IIIE ATF
Parking Brake Cable Guides	NLGI Grade 2, GC-LB
Brake Caliper Bushings	GE 661 or DOW 111 Silicone Grease
Caliper Slide Pins	GE 661 or DOW 111 Silicone Grease
Door & Hood Hinges	Light Engine Oil
Wheel Bearings	Multi-Purpose NLGI Grade 2EP, GC-LB
Drive Shaft U-Joints	Multi-Purpose NLGI Grade 2EP, GC-LB
Steering Linkage (6)(7)	Multi-Purpose NLGI Grade 2EP, GC-LB
Ball Joints (6)(8)	Multi-Purpose NLGI Grade 2EP, GC-LB
Weatherstrip	Silicone Spray Lubricant
Wheel Lug Nut Torque	80-110 ft. lbs. (115-145 N.m)

- (1) - DO NOT use Dexron-II ATF, Clutch chatter can result.
- (2) - SAE 10W-30 SH/CD is preferred.
- (3) - DO NOT use heavier weight lubricant, as it will cause axle engagement difficulties, use only SAE 80W-90 lube.
- (4) - Add 4 ozs. (118 ml) of Limited-Slip differential lubricant additive when changing fluid.
- (5) - For vehicles operating under heavy-duty towing conditions, use SAE 75W-140 Synthetic lube.  
NOTE: Before using SAE 75W-140 Synthetic, old fluid must be DRAINED and FLUSHED with clean mineral based (non-synthetic) axle lubricant. Then refill with new synthetic lube.
- (6) - Use low pressure grease gun to prevent seal damage.
- (7) - Fill until lubricant squeezes out from the base of seals.
- (8) - Fill ball joint until seal starts to swell.

## Fluid Capacities

Application	(1) Quantity
Cooling System	
2.5L (2)	10.0 Qts. (9.5L)
4.0L (3)	12.0 Qts. (11.4L)
Engine Oil (4)	
2.5L	4.0 Qts. (3.8L)
4.0L	6.0 Qts. (5.7L)

- (1) - Capacities are recommended or calculated levels. Always use dipstick (if available) to measure level.
- (2) - Includes 2.3 qts. (2.2L) for coolant recovery bottle.
- (3) - Includes 1.0 qt. (0.9L) for coolant recovery bottle.

(4) - Includes Filter.

### 112,500 MILE (180,000 KM) SERVICE

#### 112,500 MILE (180,000 KM) SERVICE

Service Or Inspect
Verify Last Major Service Was Performed
Check Fluid Levels
Check Cooling System Hoses and Clamps
Check Coolant Strength
Clean Battery and Battery Terminals
Check Exhaust System & Heat Shielding
Check Operation of Horn, Wipers/Washers & All Exterior Lights
Inspect Condition of Wiper Blades
Check Headlight Alignment
Check Seat Belt Webbing and Release Mechanisms
Check Parking Brake Operation
Check Shift/Clutch Interlock Operation
Inspect Underside of Vehicle (Bolts & Threaded Fasteners)
Inspect C/V Joint boots (4WD)
Check Drive Shaft Seals
Lubricate Ball Joints, Steering Linkage & Suspension
Lube Drive Shaft U-Joints and Slip Splines
Lube Front Axle Drive Joint and Pivot Bearings (4WD)
Lube Parking Brake Ratio Lever Pivot
Lube Manual Gearshift Control (4WD Transfer Case)
Check/Lube Manual Steering Gear
Inspect Front Brake Pads & Rotors
Inspect Rear Brake Linings & Drums
Inspect Brake System Hoses & Lines
Inspect Shocks for Leakage
Inspect Tire Wear Pattern
Lubricate Weatherstripping with Silicone

Lubricate Door Hinges
Lubricate Door Locks
Check Body Drain Holes
Rotate Tires and Adjust Air Pressure
Replace
Engine Oil
Oil Filter
Manual Transmission Fluid
Flush and Fill Engine Coolant, if not done in last 24 months

Lubrication Specifications

Application	Specification
Automatic Transmission	
30RH (3-Speed) (1)	Mopar 7176 ATF PLUS
AW4 (4-Speed)	Dexron-IIIE/Mercon ATF
Brake Master Cylinder	DOT 3 (SAE J-1703F) Brake Fluid
Engine Coolant	50/50 Ethylene-Glycol & Water Mix
Engine Oil (2)	
Temperatures Above 0°F (-18°C)	SAE 10W-30 API SH/CD ECII
Temperatures Below 32°F (0°C)	SAE 5W-30 API SH/CD ECII
Front Axle (3)	SAE 80W-90 API GL-5 (MIL-L-2105C)
Rear Axle	SAE 80W-90 API GL-5 (MIL-L-2105C)
Rear Axle (Trac-Lok) (4)	SAE 80W-140 API GL-5
Rear Axle (Trailer Towing) (5)	SAE 75W-140 Synthetic
Hydraulic Clutch	DOT 3 (SAE J-1703F) Brake Fluid
Manual Transmission	SAE 75W-90 API GL-5
Manual Steering Box	Multi-Purpose NLGI Grade 2EP
Power Steering Pump	Power Steering Fluid
Transfer Case	Dexron-IIIE ATF
Parking Brake Cable Guides	NLGI Grade 2, GC-LB
Brake Caliper Bushings	GE 661 or DOW 111 Silicone Grease
Caliper Slide Pins	GE 661 or DOW 111 Silicone Grease
Door & Hood Hinges	Light Engine Oil
Wheel Bearings	Multi-Purpose NLGI Grade 2EP, GC-LB
Drive Shaft U-Joints	Multi-Purpose NLGI Grade 2EP, GC-LB
Steering Linkage (6)(7)	Multi-Purpose NLGI Grade 2EP, GC-LB
Ball Joints (6)(8)	Multi-Purpose NLGI Grade 2EP, GC-LB
Weatherstrip	Silicone Spray Lubricant
Wheel Lug Nut Torque	80-110 ft. lbs. (115-145 N.m)
(1) - DO NOT use Dexron-II ATF, Clutch chatter can result.	
(2) - SAE 10W-30 SH/CD is preferred.	
(3) - DO NOT use heavier weight lubricant, as it will cause axle engagement difficulties, use only SAE 80W-90 lube.	
(4) - Add 4 ozs. (118 ml) of Limited-Slip differential lubricant additive when changing fluid.	
(5) - For vehicles operating under heavy-duty towing conditions, use SAE 75W-140 Synthetic lube.	
NOTE: Before using SAE 75W-140 Synthetic, old fluid must be DRAINED and FLUSHED with clean mineral based (non-synthetic) axle lubricant. Then refill with new synthetic lube.	
(6) - Use low pressure grease gun to prevent seal damage.	



- (7) - Fill until lubricant squeezes out from the base of seals.
- (8) - Fill ball joint until seal starts to swell.

Fluid Capacities

Application	(1) Quantity
Automatic Transmission (2)	
30RH (3-Speed)	
Fluid Change .....	4.0 Qts. (3.8L)
Overhaul (Dry Fill) .....	8.75 Qts. (8.2L)
AW4 (4-Speed)	
Fluid Change .....	2.0 Qts. (1.7L)
Overhaul (Dry Fill) .....	8.5 Qts. (8.0L)
Cooling System	
2.5L (3) .....	10.0 Qts. (9.5L)
4.0L (4) .....	12.0 Qts. (11.4L)
Engine Oil (5)	
2.5L .....	4.0 Qts. (3.8L)
4.0L .....	6.0 Qts. (5.7L)
Manual Transmission (6)	
AX4 (4-Speed AISIN) .....	7.4 Pts. (3.5L)
T4 (Borg-Warner) .....	3.9 Pts. (1.8L)
AX5 (5-Speed AISIN)	
2.5L (2WD) .....	7.0 Pts. (3.5L)
2.5L (4X4) .....	6.6 Pts. (3.2L)
T5 (Borg-Warner) .....	4.5 Pts. (2.1L)
AX15 (5-Speed AISIN)	
4.0L (2WD) .....	6.4 Pts. (3.1L)
4.0L (4X4) .....	6.5 Pts. (3.15L)
Transfer Case	
Command-Trac (NV 231) .....	2.2 Pts. (1.0L)
Selec-Trac (NV 242) .....	3.0 Pts. (1.4L)
Drive Axles (6)	
Front Axle (Model 30)	
Command-Trac (Disconnect) .....	3.76 Pts. (1.65L)
(Disconnect Housing) (7) .....	5.0 Ozs. (0.15L)
Selec-Trac (Non-Disconnect) .....	3.13 Pts. (1.5L)
Rear Axle	
1989-94 (8) .....	2.5 Pts. (1.2L)
1995-96	
Model 35 (8) .....	3.5 Pts. (1.6L)
8-1/4" (8) .....	4.4 Pts. (2.1L)

- (1) - Capacities are recommended or calculated levels. Always use dipstick (if available) to measure level.
- (2) - Total quantity required will vary, after adding amount shown check dipstick and fill to proper level.
- (3) - Includes 2.3 qts. (2.2L) for coolant recovery bottle.
- (4) - Includes 1.0 qt. (0.9L) for coolant recovery bottle.
- (5) - Includes Filter.
- (6) - Fill to bottom edge of filler plug hole.
- (7) - Add 5 ozs. of gear lubricant through indicator switch hole.
- (8) - If equipped with TRAC-LOK, add 4 ozs. of Limited-Slip differential lubricant additive first, then add new fluid.

**120,000 MILE (192,000 KM) SERVICE**

120,000 MILE (192,000 KM) SERVICE

Service Or Inspect

	Verify Last Major Service Was Performed
	Check Fluid Levels
	Check Cooling System Hoses and Clamps
	Check Coolant Strength
	Check Exhaust System & Heat Shielding
	Clean/Inspect Battery and Battery Terminals
	Check/Adjust Accessory Drive Belts
	Ignition Timing
	Clean EGR Passages (if equipped)
	Check/Lube Manual Steering Gear
	Inspect Underside of Vehicle (Bolts & Threaded Fasteners)
	Inspect C/V Joint boots (4WD)
	Check Drive Shaft Seals
	Lubricate Ball Joints, Steering Linkage & Suspension
	Lube Drive Shaft U-Joints and Slip Splines
	Lube Front Axle Drive Joint and Pivot Bearings (4WD)
	Suspension Bushings, Springs, Arms & Rear Jounce Bumpers
	Parking Brake System
	Inspect Shocks for Leakage
	Inspect Tire Wear Pattern
	Rotate Tires and Adjust Air Pressure (Including Spare)
	Replace
	Engine Oil
	Oil Filter
	Spark Plugs
	Ignition Cables
	Distributor Cap and Rotor
	Air Filter Element
	Fuel Filter (In-Line)
	PCV Valve (1)
	PCV Filter

EGR Valve & Tube (1989-92)
Emission System Vacuum Hoses
Vacuum Operated Emission Components (1989-92)
Drive Belt (V-Type) (2)
Flush and Fill Engine Coolant, if not done in last 24 months
Automatic Transmission Fluid, Filter and Adjust Bands
Transfer Case Fluid
Front & Rear Axle Fluid

- (1) - Replacement is recommended by Chrysler at this time, but it is not required to maintain the warranty on the PCV valve.
- (2) - Check and replace as needed.

Lubrication Specifications

Application	Specification
Automatic Transmission	
30RH (3-Speed) (1)	Mopar 7176 ATF PLUS
AW4 (4-Speed)	Dexron-IIIE/Mercon ATF
Brake Master Cylinder	DOT 3 (SAE J-1703F) Brake Fluid
Engine Coolant	50/50 Ethylene-Glycol & Water Mix
Engine Oil (2)	
Temperatures Above 0°F (-18°C)	SAE 10W-30 API SH/CD ECII
Temperatures Below 32°F (0°C)	SAE 5W-30 API SH/CD ECII
Front Axle (3)	SAE 80W-90 API GL-5 (MIL-L-2105C)
Rear Axle	SAE 80W-90 API GL-5 (MIL-L-2105C)
Rear Axle (Trac-Lok) (4)	SAE 80W-140 API GL-5
Rear Axle (Trailer Towing) (5)	SAE 75W-140 Synthetic
Hydraulic Clutch	DOT 3 (SAE J-1703F) Brake Fluid
Manual Transmission	SAE 75W-90 API GL-5
Manual Steering Box	Multi-Purpose NLGI Grade 2EP
Power Steering Pump	Power Steering Fluid
Transfer Case	Dexron-IIIE ATF
Parking Brake Cable Guides	NLGI Grade 2, GC-LB
Brake Caliper Bushings	GE 661 or DOW 111 Silicone Grease
Caliper Slide Pins	GE 661 or DOW 111 Silicone Grease
Door & Hood Hinges	Light Engine Oil
Wheel Bearings	Multi-Purpose NLGI Grade 2EP, GC-LB
Drive Shaft U-Joints	Multi-Purpose NLGI Grade 2EP, GC-LB
Steering Linkage (6)(7)	Multi-Purpose NLGI Grade 2EP, GC-LB
Ball Joints (6)(8)	Multi-Purpose NLGI Grade 2EP, GC-LB
Weatherstrip	Silicone Spray Lubricant
Wheel Lug Nut Torque	80-110 ft. lbs. (115-145 N.m)
(1) - DO NOT use Dexron-II ATF, Clutch chatter can result.	
(2) - SAE 10W-30 SH/CD is preferred.	
(3) - DO NOT use heavier weight lubricant, as it will cause axle engagement difficulties, use only SAE 80W-90 lube.	
(4) - Add 4 ozs. (118 ml) of Limited-Slip differential lubricant additive when changing fluid.	
(5) - For vehicles operating under heavy-duty towing conditions, use SAE 75W-140 Synthetic lube.	
NOTE: Before using SAE 75W-140 Synthetic, old fluid must be DRAINED and FLUSHED with clean mineral based (non-synthetic) axle lubricant. Then refill with new synthetic lube.	

- (6) - Use low pressure grease gun to prevent seal damage.
- (7) - Fill until lubricant squeezes out from the base of seals.
- (8) - Fill ball joint until seal starts to swell.

Fluid Capacities

Application	(1) Quantity
Automatic Transmission (2)	
30RH (3-Speed)	
Fluid Change .....	4.0 Qts. (3.8L)
Overhaul (Dry Fill) .....	8.75 Qts. (8.2L)
AW4 (4-Speed)	
Fluid Change .....	2.0 Qts. (1.7L)
Overhaul (Dry Fill) .....	8.5 Qts. (8.0L)
Cooling System	
2.5L (3) .....	10.0 Qts. (9.5L)
4.0L (4) .....	12.0 Qts. (11.4L)
Engine Oil (5)	
2.5L .....	4.0 Qts. (3.8L)
4.0L .....	6.0 Qts. (5.7L)
Manual Transmission (6)	
AX4 (4-Speed AISIN) .....	7.4 Pts. (3.5L)
T4 (Borg-Warner) .....	3.9 Pts. (1.8L)
AX5 (5-Speed AISIN)	
2.5L (2WD) .....	7.0 Pts. (3.5L)
2.5L (4X4) .....	6.6 Pts. (3.2L)
T5 (Borg-Warner) .....	4.5 Pts. (2.1L)
AX15 (5-Speed AISIN)	
4.0L (2WD) .....	6.4 Pts. (3.1L)
4.0L (4X4) .....	6.5 Pts. (3.15L)
Transfer Case	
Command-Trac (NV 231) .....	2.2 Pts. (1.0L)
Selec-Trac (NV 242) .....	3.0 Pts. (1.4L)
Drive Axles (6)	
Front Axle (Model 30)	
Command-Trac (Disconnect) .....	3.76 Pts. (1.65L)
(Disconnect Housing) (7) .....	5.0 Ozs. (0.15L)
Selec-Trac (Non-Disconnect) .....	3.13 Pts. (1.5L)
Rear Axle	
1989-94 (8) .....	2.5 Pts. (1.2L)
1995-96	
Model 35 (8) .....	3.5 Pts. (1.6L)
8-1/4" (8) .....	4.4 Pts. (2.1L)

- (1) - Capacities are recommended or calculated levels. Always use dipstick (if available) to measure level.
- (2) - Total quantity required will vary, after adding amount shown check dipstick and fill to proper level.
- (3) - Includes 2.3 qts. (2.2L) for coolant recovery bottle.
- (4) - Includes 1.0 qt. (0.9L) for coolant recovery bottle.
- (5) - Includes Filter.
- (6) - Fill to bottom edge of filler plug hole.
- (7) - Add 5 ozs. of gear lubricant through indicator switch hole.
- (8) - If equipped with TRAC-LOK, add 4 ozs. of Limited-Slip differential lubricant additive first, then add new fluid.

Service Labor Times

Application	(1) Hours
1989-92	
2.5L	

Automatic Transmission .....	9.3
Manual Transmission .....	7.5
4.0L	
Automatic Transmission .....	10.1
Manual Transmission .....	8.3
1993-96	
2.5L	
Automatic Transmission .....	7.6
Manual Transmission .....	5.8
4.0L	
Automatic Transmission .....	7.8
Manual Transmission .....	6.0

(1) - Add .6 hour for vehicles equipped with 4WD.

## LUBRICATION SPECIFICATIONS

### LUBRICATION SPECIFICATIONS TABLE

Application	Specification
Automatic Transmission	
30RH (3-Speed) (1) .....	Mopar 7176 ATF PLUS
AW4 (4-Speed) .....	Dexron-III/Mercon ATF
Brake Master Cylinder .....	DOT 3 (SAE J-1703F) Brake Fluid
Coolant .....	50/50 Ethylene-Glycol & Water Mix
Engine Oil (2)	
Temperature Range	
Above 0° F (-18°C) .....	SAE 10W-30 API SH/CD ECII
Less Than 60° F (16°C) .....	SAE 5W-30 API SH/CD ECII
Front Axle (3) .....	SAE 80W-90 API GL-5 (MIL-L-2105C)
Rear Axle .....	SAE 80W-90 API GL-5 (MIL-L-2105C)
Rear Axle (Trac-Lok) (4) .....	SAE 80W-140 API GL-5
Rear Axle (Trailer Towing) (5) .....	SAE 75W-140 Synthetic
Hydraulic Clutch .....	DOT 3 (SAE J-1703F) Brake Fluid
Manual Transmission .....	SAE 75W-90 API GL-5
Manual Steering Box .....	Multi-Purpose NLGI Grade 2EP
Power Steering Pump .....	Power Steering Fluid
Transfer Case .....	Dexron-IIIE ATF
Brake Caliper Bushings .....	GE 661 or DOW 111 Silicone Grease
Caliper Slide Pins .....	GE 661 or DOW 111 Silicone Grease
Wheel Bearings .....	Multi-Purpose NLGI Grade 2EP, GC-LB
Drive Shaft U-Joints .....	Multi-Purpose NLGI Grade 2EP, GC-LB
Steering Linkage (6)(7) ...	Multi-Purpose NLGI Grade 2EP, GC-LB
Ball Joints (6)(8) .....	Multi-Purpose NLGI Grade 2EP, GC-LB
Weatherstrip .....	Silicone Spray Lubricant

- (1) - DO NOT use Dexron-III ATF, Clutch chatter can result.
- (2) - SAE 10W-30 SH/CD is preferred.
- (3) - DO NOT use heavier weight lubricant, as it will cause axle engagement difficulties, use only SAE 80W-90 lube.
- (4) - Add 4 ozs. (118 ml) of Limited-Slip differential lubricant additive when changing fluid.
- (5) - For vehicles operating under heavy-duty towing conditions, use SAE 75W-140 Synthetic lube.  
NOTE: Before using SAE 75W-140 Synthetic the old fluid must be DRAINED and FLUSHED with clean mineral based (non-synthetic) axle lubricant. Then refill with new synthetic lube.
- (6) - Use low pressure grease gun to prevent seal damage.
- (7) - Fill until lubricant squeezes out from the base of seals.
- (8) - Fill ball joint until seal starts to swell.

## FLUID CAPACITIES

FLUID CAPACITIES TABLE

Application	Quantity (1)
A/C System R-12 Refrigerant Capacity	
1989-90 .....	36-40 Ozs.
1991-93	
Cherokee 2-Door .....	32 Ozs.
Cherokee 4-Door .....	38 Ozs.
A/C System R-134a Refrigerant Capacity (2)	
1994-96 .....	32 Ozs.
Automatic Transmission (3)	
30RH (3-Speed)	
Fluid Change .....	4.0 Qts. (3.8L)
Overhaul (Dry Fill) .....	8.75 Qts. (8.2L)
AW4 (4-Speed)	
Fluid Change .....	2.0 Qts. (1.7L)
Overhaul (Dry Fill) .....	8.5 Qts. (8.0L)
Cooling System	
2.5L (4) .....	10.0 Qts. (9.5L)
4.0L (5) .....	12.0 Qts. (11.4L)
Engine Oil (6)	
2.5L .....	4.0 Qts. (3.8L)
4.0L .....	6.0 Qts. (5.7L)
Fuel Tank .....	20.2 Gals. (76.4L)
Manual Transmission (7)	
AX4 (4-Speed AISIN) .....	7.4 Pts. (3.5L)
T4 (4-Speed Borg-Warner) .....	3.9 Pts. (1.8L)
AX5 (5-Speed AISIN)	
2.5L (2WD) .....	7.0 Pts. (3.5L)
2.5L (4X4) .....	6.6 Pts. (3.2L)
T5 (5-Speed Borg-Warner) .....	4.5 Pts. (2.1L)
AX15 (5-Speed AISIN)	
4.0L (2WD) .....	6.4 Pts. (3.1L)
4.0L (4X4) .....	6.5 Pts. (3.15L)
Transfer Case	
Command-Trac (NV 231) .....	2.2 Pts. (1.0L)
Selec-Trac (NV 242) .....	3.0 Pts. (1.4L)
Drive Axles (7)	
Front Axle (Model 30)	
Command-Trac (Disconnect) .....	3.76 Pts. (1.65L)
(Disconnect Housing) (8) .....	5.0 Ozs. (0.15L)
Selec-Trac (Non-Disconnect) .....	3.13 Pts. (1.5L)
Rear Axle	
1989-94 (9) .....	2.5 Pts. (1.2L)
1995-96	
Model 35 (9) .....	3.5 Pts. (1.6L)
8-1/4" (9) .....	4.4 Pts. (2.1L)

- (1) - Capacities are recommended or calculated levels. Always use dipstick (if available) to measure level.
- (2) - Use of R-12 in a R-134a system will result in SEVERE DAMAGE
- (3) - Total quantity required will vary, after adding amount shown check dipstick and fill to proper level.
- (4) - Includes 2.3 qts. (2.2L) for coolant recovery bottle.
- (5) - Includes 1.0 qt. (0.9L) for coolant recovery bottle.
- (6) - Includes Filter.
- (7) - Fill to bottom edge of filler plug hole.

- (8) - Add 5 ozs. of gear lubricant through indicator switch hole.
  - (9) - If equipped with TRAC-LOK, add 4 ozs. of Limited-Slip differential lubricant additive first, then add new fluid.
-